

REVISED '57
REVISED '60
" '74
" '77
" '80
" '81
" '88
" '91
Revised 1997
Revised 1999
Revised 2000

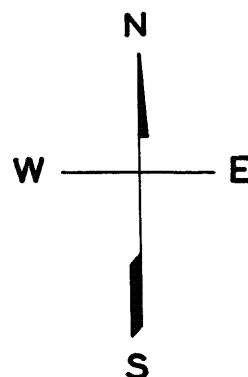

LOTS	13	INTO LOT-12-1943
"	14	" " 12 "
"	15	" " 12 "
"	24	" " 2 '53'
"	10	" " 9 '54'

lot9 into lots47to52 for 1997 roll
lot5 into lots53 & 54 for 2000 roll
lots42/44 into lots57/62 for 1999 roll

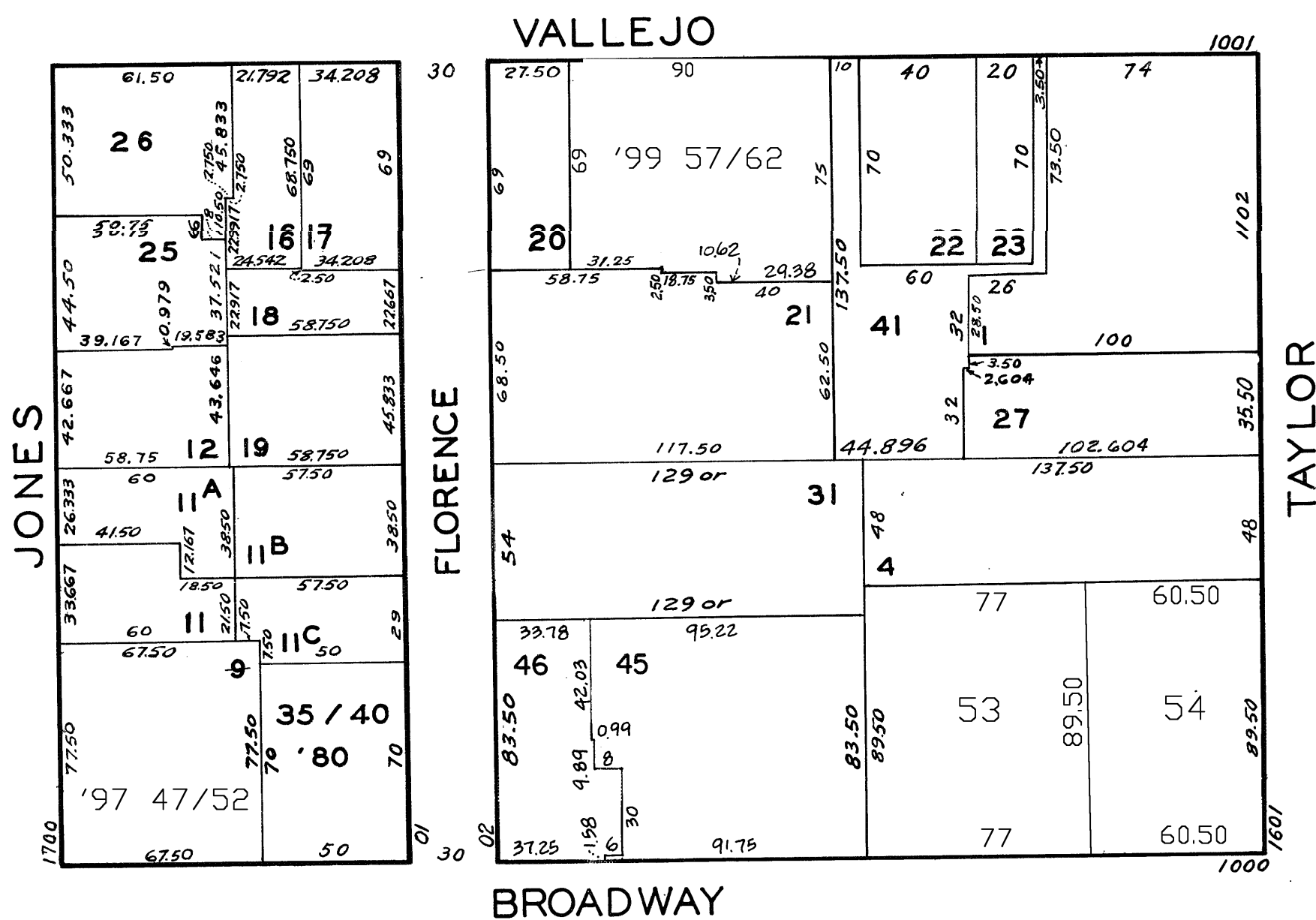

LOT NO.	UNIT NO.	% COMMON AREA
35	1	5.2
36	2	16.4
37	3	17.9
38	4	16.4
39	5	17.9
40	6	26.2

LOT	UNIT	% COMM.	AREA
57	1035	16	
58	1037	15	
59	1039	17	
60	1041	17	
61	1043	18	
62	1045	17	

<u>LOT</u>	<u>UNIT</u>	<u>% COMM. AREA</u>
47	1	18.77
48	2	13.21
49	3	22.24
50	4	13.21
51	5	19.36
52	6	13.21

ASSESSED 105,188
BLK. TOTAL 105,188 SQ. FT.