

REVISED	'66

Revised 1998  
Revised 2009  
Revised 2012

© COPYRIGHT SAN FRANCISCO  
CITY & COUNTY ASSESSOR 1995

## LOTS MERGED

LOTS 3 INTO LOT-2 1943  
 " 11 " " 10- "  
 " 46B " " 46-1926  
 " 46A " " 52-1933  
 39, 40, 41A, 42A, 43A  
 44A, 45 & 48/49 ST '1953'

lot32 into lots55&56 for 1998 roll  
lot9 into lots57to59 for 2009 roll  
lot52 into lots60&61 for 2012 roll

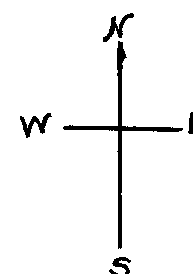

BROADWAY

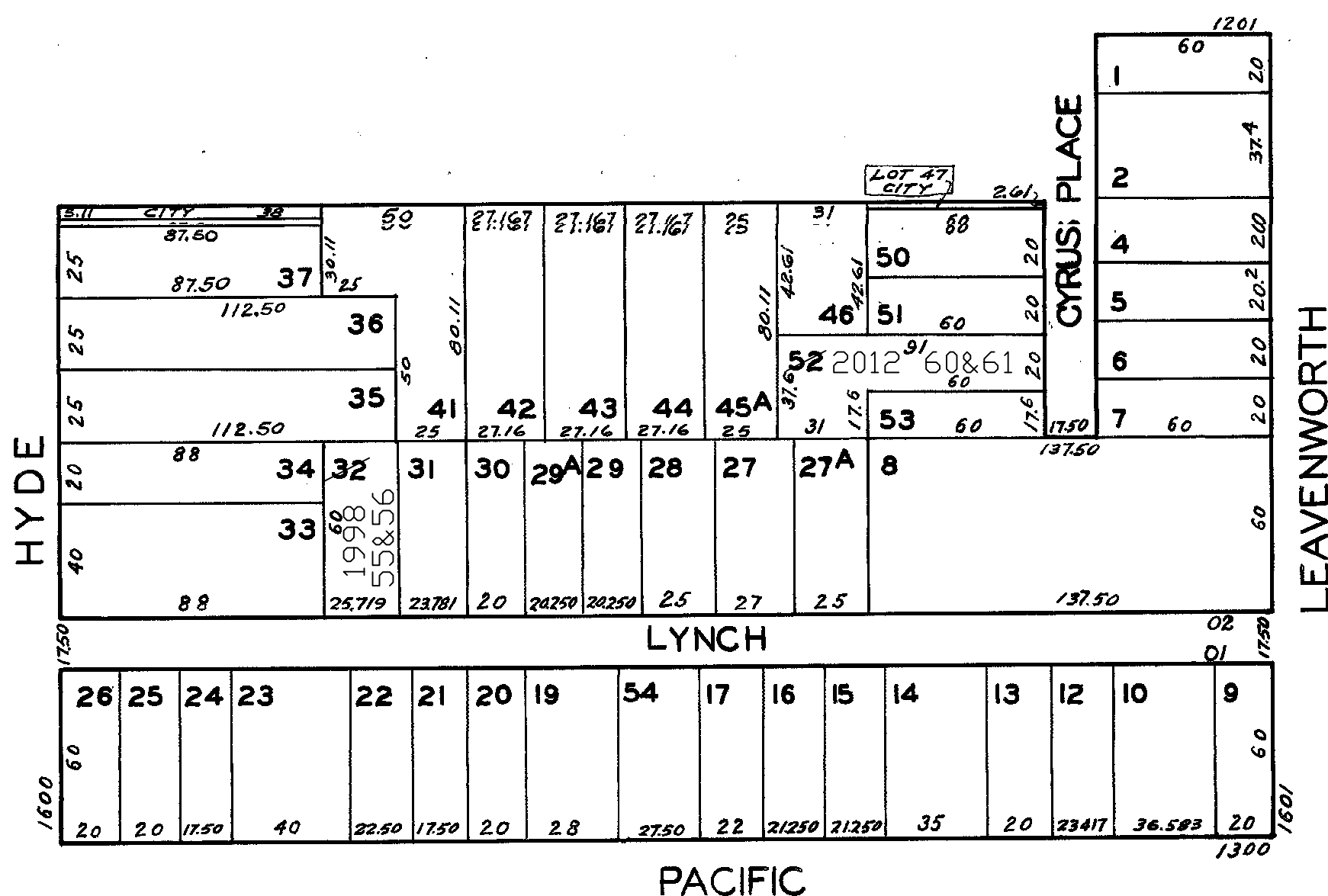

<u>72-74 LYNCH ST.</u>		
<u>A CONDOMINIUM</u>		
<u>LOT</u>	<u>UNIT</u>	<u>% COMM. AREA</u>
55	72	50
56	74	50

ASSESSED	83,983
CITY	604
BLK. TOTAL	84,587 SQ. FT.