

REVISÉ '86

11 '93

Revised 2010

LOTS MERGED

LOT 12 INTO LOT 11-22
Lot 19^B merged into lot 20 43
lot16 into lots61/63 for 2010 roll

© COPYRIGHT SAN FRANCISCO
CITY & COUNTY ASSESSOR 1995

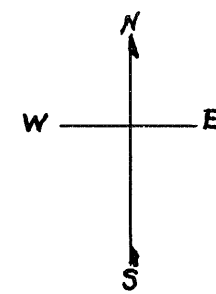

JACKSON

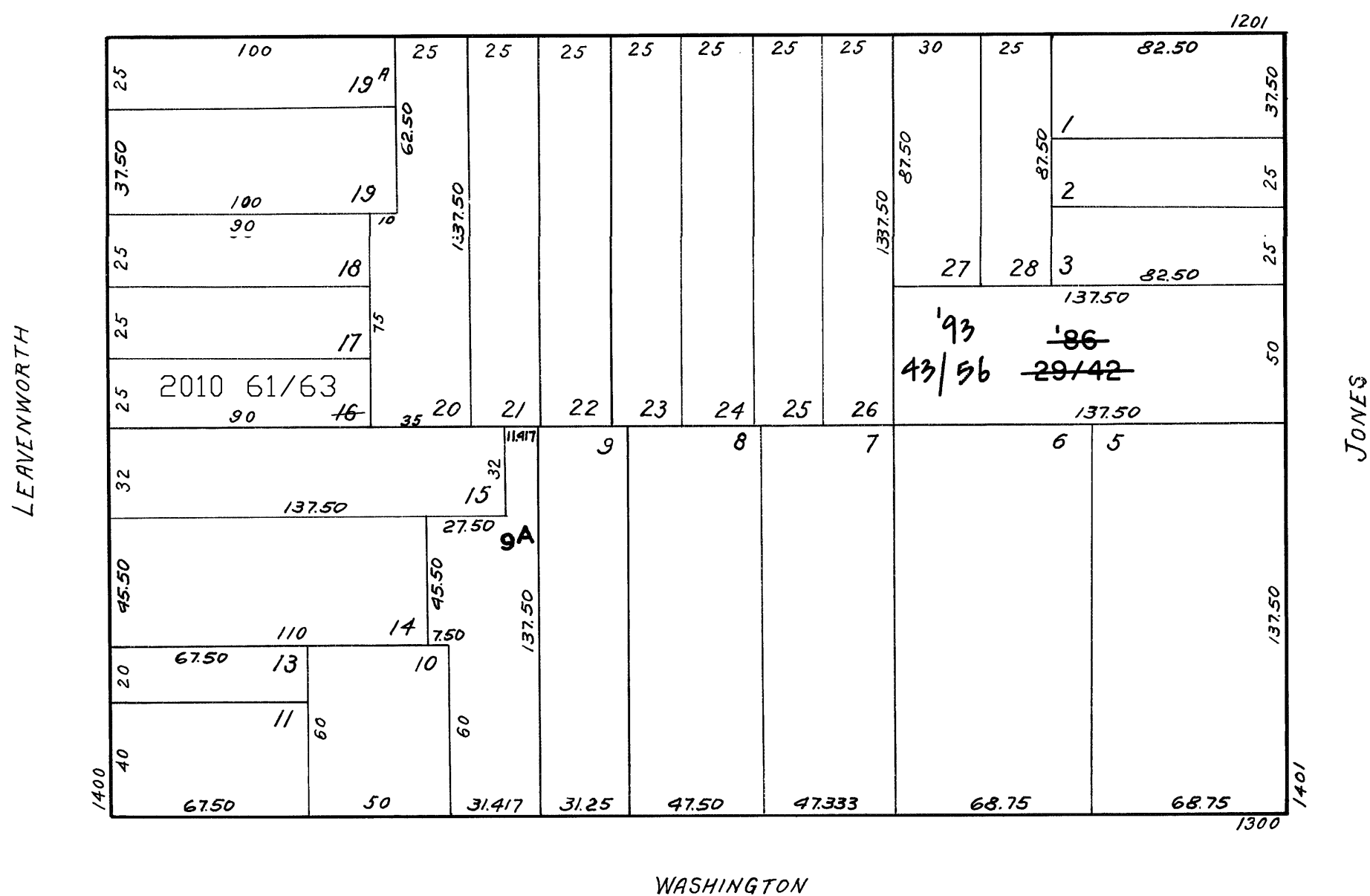

1441 JONES ST.

A CONDOMINIUM

LOT	UNIT	% COMM. AREA
29	201	11.8
30	202	7.8
31	301	5.6
32	302	5.5
33	303	7.8
34	304	7.9
35	401	5.6
36	402	5.5
37	403	7.8
38	404	7.9
39	501	5.6
40	502	5.5
41	503	7.8
42	504	7.9

1441 JONES ST.

A CONDOMINIUM

LOT	UNIT	% COMM. AREA
43	201	3.96
44	202	5.74
45	301	6.14
46	302	5.96
47	303	11.10
48	304	8.64
49	401	6.14
50	402	5.96
51	403	8.49
52	404	8.64
53	501	6.14
54	502	5.96
55	503	8.49
56	504	8.64