

Lot 1E merged into lots 1 & 10 - '26  
Lots 4/6 merged into lot 3 - '44

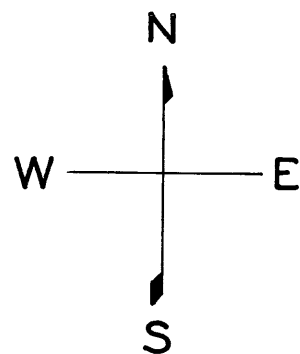

W A BLK. 184

REVISED '83  
" '89

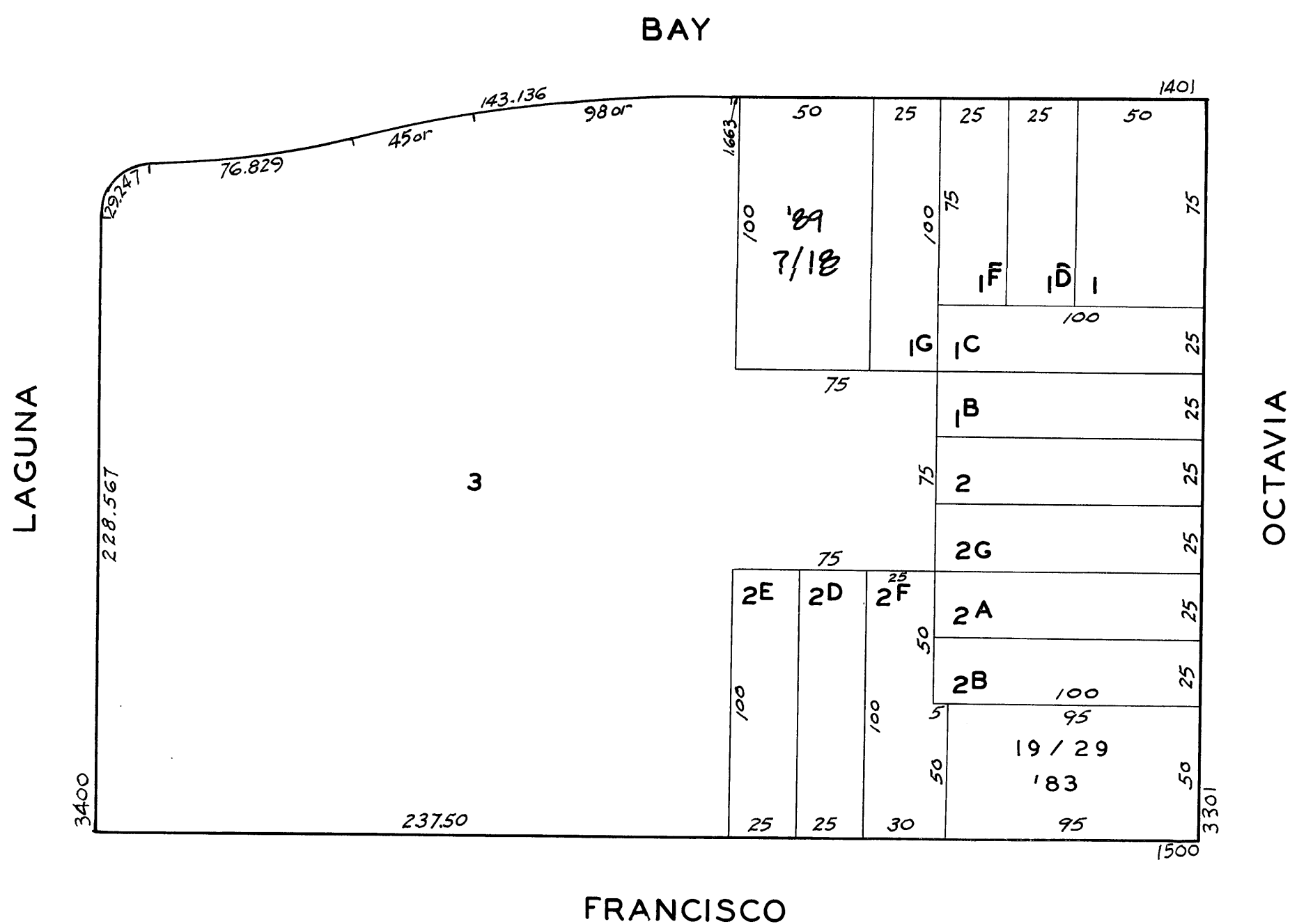

1435 BAY ST. A CONDOMINIUM		
LOT	UNIT	% COMM. AREA
7	1	8.275
8	2	8.249
9	3	8.405
10	4	8.405
11	21	8.274
12	22	8.249
13	23	8.405
14	24	8.405
15	31	8.274
16	32	8.249
17	33	8.405
18	34	8.405

1500 FRANCISCO ST. A CONDOMINIUM		
LOT NO.	UNIT NO.	% COMMON AREA
19	1	6.458
20	2	8.207
21	3	8.238
22	4	6.511
23	5	6.458
24	6	8.207
25	7	8.238
26	8	6.511
27	9	8.207
28	10	17.803
29	11	15.162