

ASSESSOR-RECORDER'S OFFICE

LOTS MERGED

LOT 12 INTO LOT 13 - 1932
" 5A/6 " " 5 - 1944

935

W A B L K. 488

Revised 1998
Revised 2000
Revised 2002

© COPYRIGHT SAN FRANCISCO
CITY & COUNTY ASSESSOR 1995

lot15 into lots22&23 for 1998 roll
lot16 into lots20&21 for 2000 roll
lot18 into lots24&25 for 2002 roll

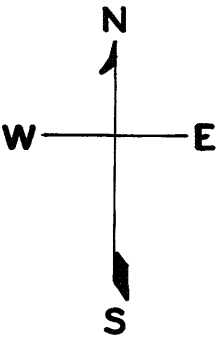

CHESTNUT

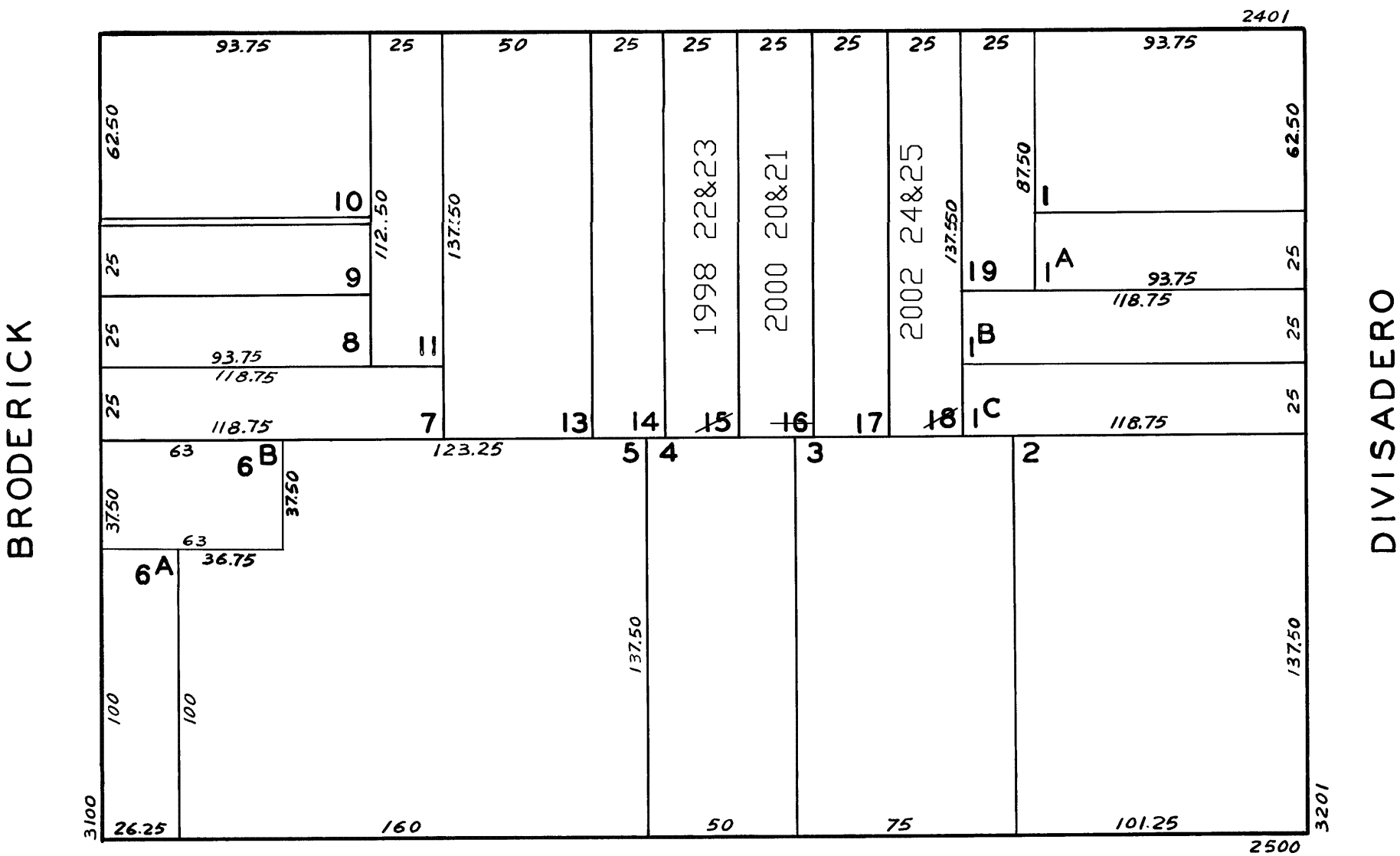

LOMBARD

2441-2443 CHESTNUT ST.			
A CONDOMINIUM			
LOT	UNIT	% COMM.	AREA
20	2441	47.02	
21	2443	52.98	

2429-2431 CHESTNUT ST.			
A CONDOMINIUM			
LOT	UNIT	% COMM.	AREA
24	2429	50	
25	2431	50	

2447-2449 CHESTNUT ST.			
A CONDOMINIUM			
LOT	UNIT	% COMM.	AREA
22	2447	47.07	
23	2449	52.93	