

lot29 into lots67&68 for 2008 roll
lot25 into lots69to71 for 2013 roll
Lot 30 into lots 72 to 75 for 2015 roll
Lot 26 into lots 76 & 77 for 2016 roll

1005

W A BLK. 542

REVISED '60
" '82
" '83
" '88
" '91
" '92
" '94
" '96
Revised 2008
Revised 2013
REVISED 2015
REVISED 2016

3065 CLAY ST.
A CONDOMINIUM

LOT NO.	UNIT NO.	% COMMON AREA
33	1	7.252
34	2	7.556
35	3	8.982
36	4	8.288
37	5	8.341
38	6	8.190
39	7	9.062
40	8	8.368
41	9	8.341
42	10	8.190
43	11	9.062
44	12	8.368

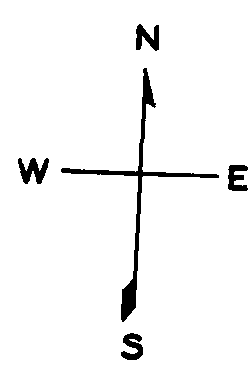

3051 CLAY ST.
A CONDOMINIUM

LOT	UNIT	% COMM. AREA
60	3055A	12
61	3055	28
62	3053	30
63	3051	30

1938-1940 BAKER ST.
A CONDOMINIUM

LOT	UNIT	% COMM. AREA
64	1938	43
65	1940	57

CLAY

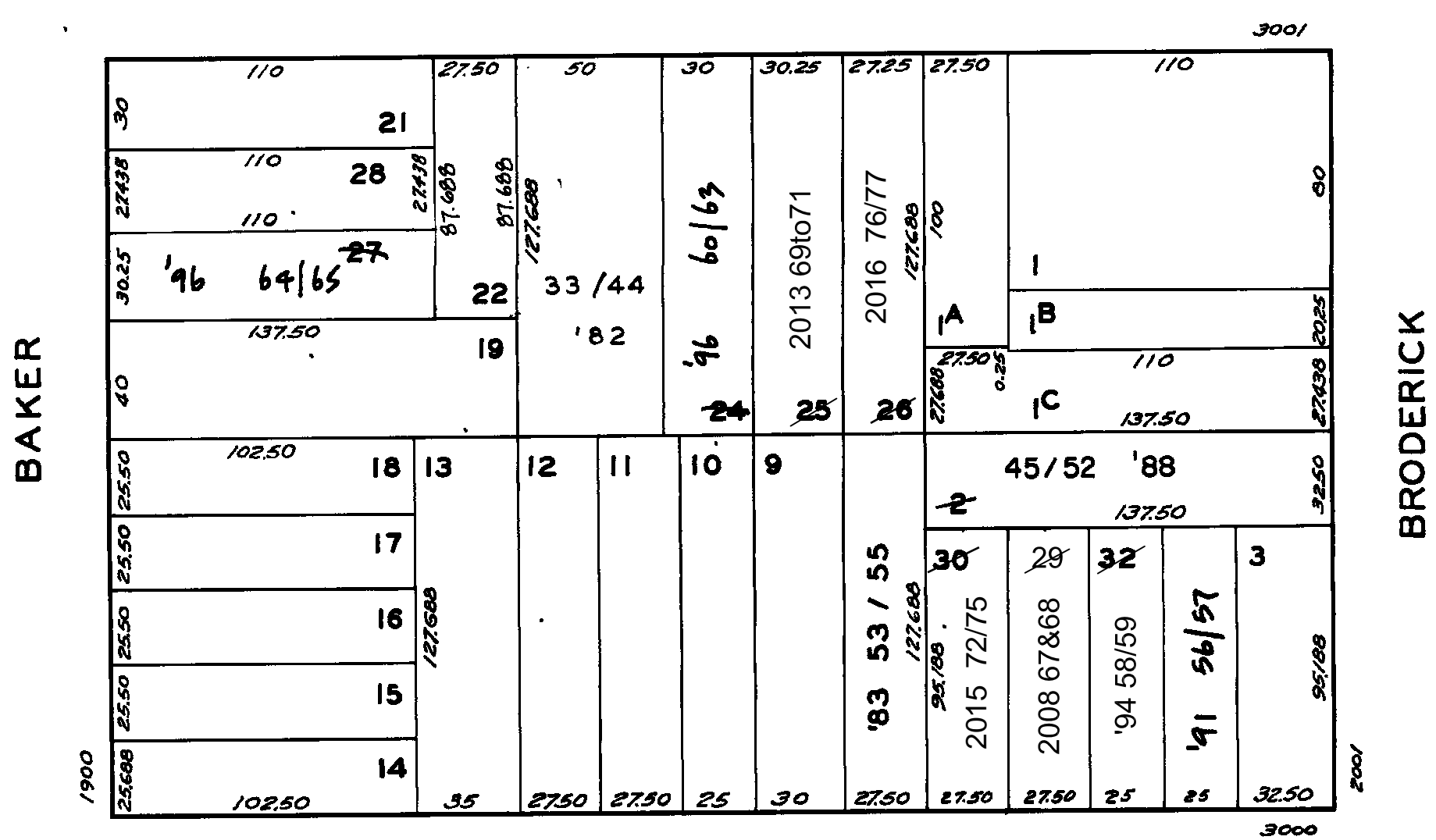

SACRAMENTO

2025 BRODERICK ST
A CONDOMINIUM

LOT	UNIT	% COMM. AREA
45	1	1/8
46	2	1/8
47	3	1/8
48	4	1/8
49	5	1/8
50	6	1/8
51	7	1/8
52	8	1/8

3014 - 18 SACRAMENTO ST.
A CONDOMINIUM

LOT NO.	UNIT NO.	% COMMON AREA
53	3014	26
54	3016	35
55	3018	39

3004 - 3004A SACRAMENTO ST.
A CONDOMINIUM

LOT	UNIT	% COMM. AREA
56	3004	47.11
57	3004A	52.89

3006 - 3006A SACRAMENTO ST.
A CONDOMINIUM

LOT	UNIT	% COMM. AREA
58	3006	50.22
59	3006A	49.78