

1226

W. A. BLK. 691

11 '95

lot 9 into lots 44/46 for 2000 roll
lot3 into lots47&48 for 2002 roll
lot24 into lots51to53 for 2008 roll
lot8 into lots54&55 for 2009 roll
lot13 into lots56to59 for 2011 roll

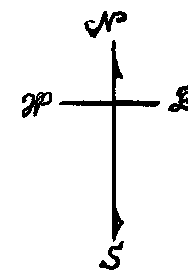

OAK

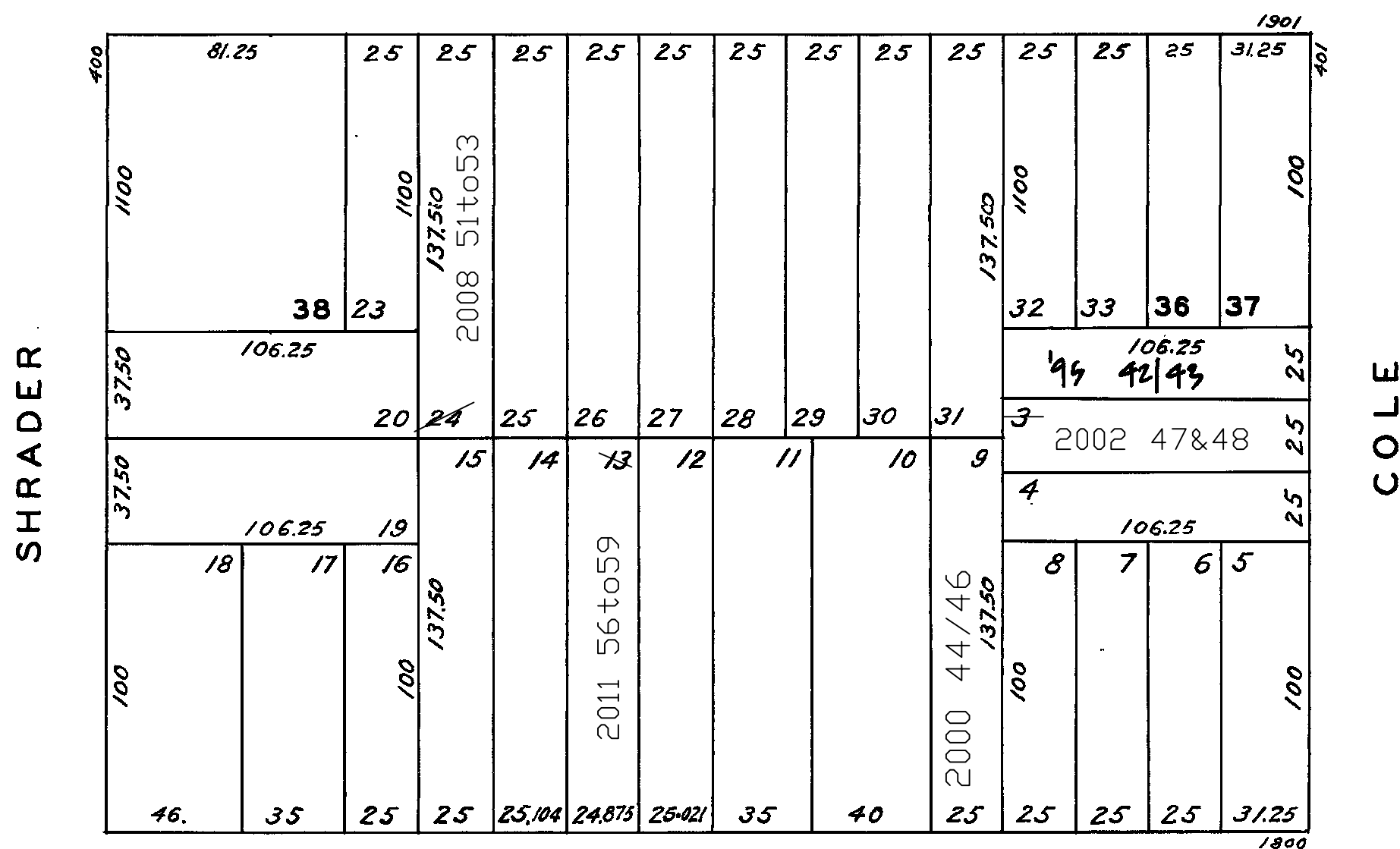

PAGE

| | | |
|----|------|------|
| 44 | 1826 | 32.7 |
| 45 | 1828 | 29.9 |
| 46 | 1830 | 39.4 |

| LOT | UNIT | % COMM. AREA |
|-----|------|--------------|
| 42 | 437 | 52 |
| 43 | 439 | 48 |

| | | |
|----|-----|-------|
| 47 | 441 | 51.70 |
| 48 | 443 | 48.30 |