

REVISED 1970
" 181
" 190
Revised 2009

© COPYRIGHT SAN FRANCISCO
CITY & COUNTY ASSESSOR 1995

lot19 into lots88&89 for 2009 roll

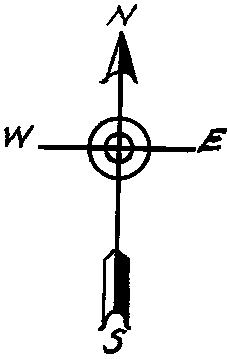

GEARY BLVD.

8TH AVE.

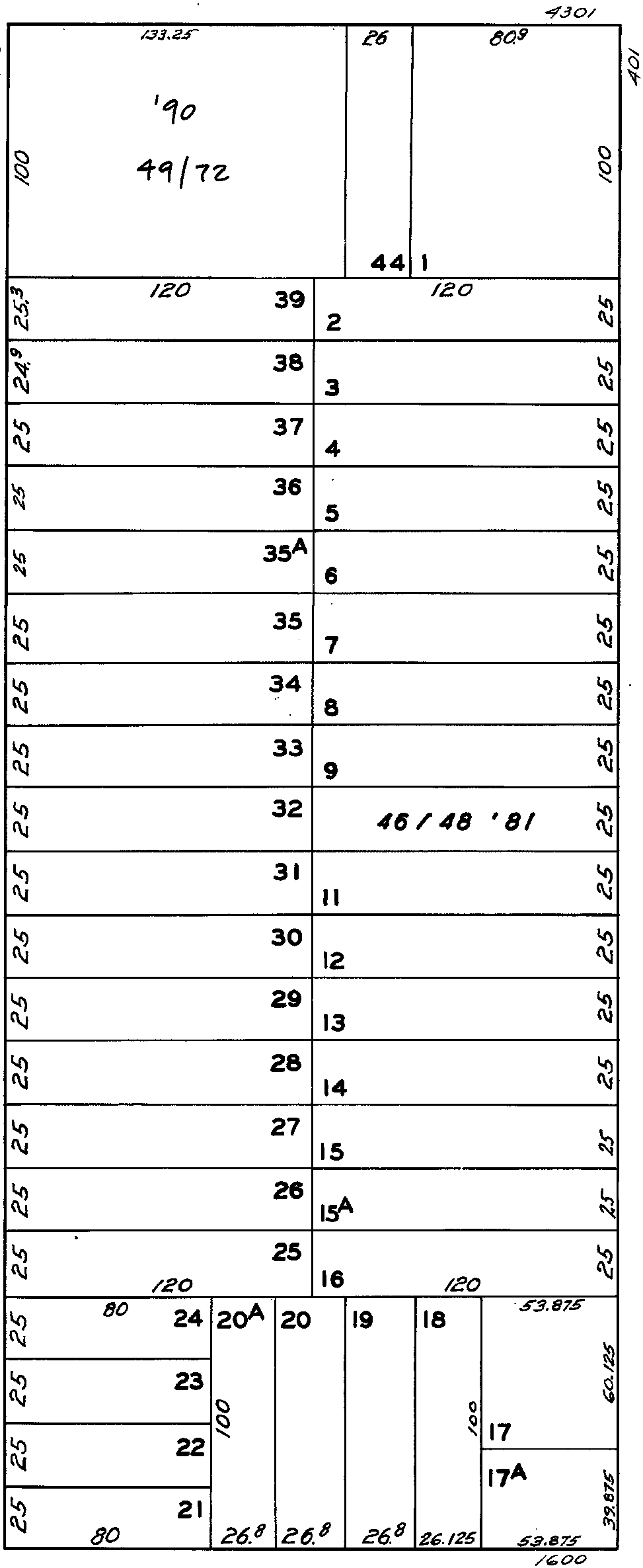

ANZA

GEARY PLAZA

A CONDOMINIUM

| LOT | UNIT | % COMM. AREA |
|-----|------|--------------|
| 49 | 1 | 9.41 |
| 50 | 2 | 17.41 |
| 51 | 3 | 2.18 |
| 52 | 4 | 4.18 |
| 53 | 5 | 4.19 |
| 54 | 6 | 3.46 |
| 55 | 7 | 3.00 |
| 56 | 8 | 3.00 |
| 57 | 9 | 2.29 |
| 58 | 10 | 3.49 |
| 59 | 11 | 3.85 |
| 60 | 12 | 4.04 |
| 61 | 13 | 3.74 |
| 62 | 14 | 2.87 |
| 63 | 15 | 2.91 |
| 64 | 16 | 2.92 |
| 65 | 17 | 3.39 |
| 66 | 18 | 3.83 |
| 67 | 19 | 4.03 |
| 68 | 20 | 3.73 |
| 69 | 21 | 2.87 |
| 70 | 22 | 2.91 |
| 71 | 23 | 2.92 |
| 72 | 24 | 3.39 |

7TH AVE.

451 7TH AVE

A CONDOMINIUM

| LOT NO. | UNIT NO. | % COMMON AREA |
|---------|----------|---------------|
| 46 | 101 | 24.76 |
| 47 | 102 | 23.21 |
| 48 | 201 | 52.03 |