

LOTS MERGED

Lot 44 merged into lot 1/19-"1918"
" 19 " " " 18-"1944"
lot40 into lots46&47 for 2003 roll
lot12 into lots44&45 for 2005 roll
lot31 into lots48&49 for 2006 roll

© COPYRIGHT SAN FRANCISCO
CITY & COUNTY ASSESSOR 1995

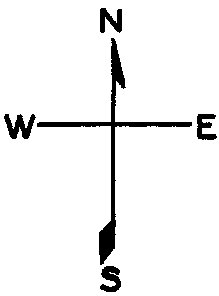

1561

RICHMOND BLK. 301
Revised 2003
Revised 2005
Revised 2006

ANZA

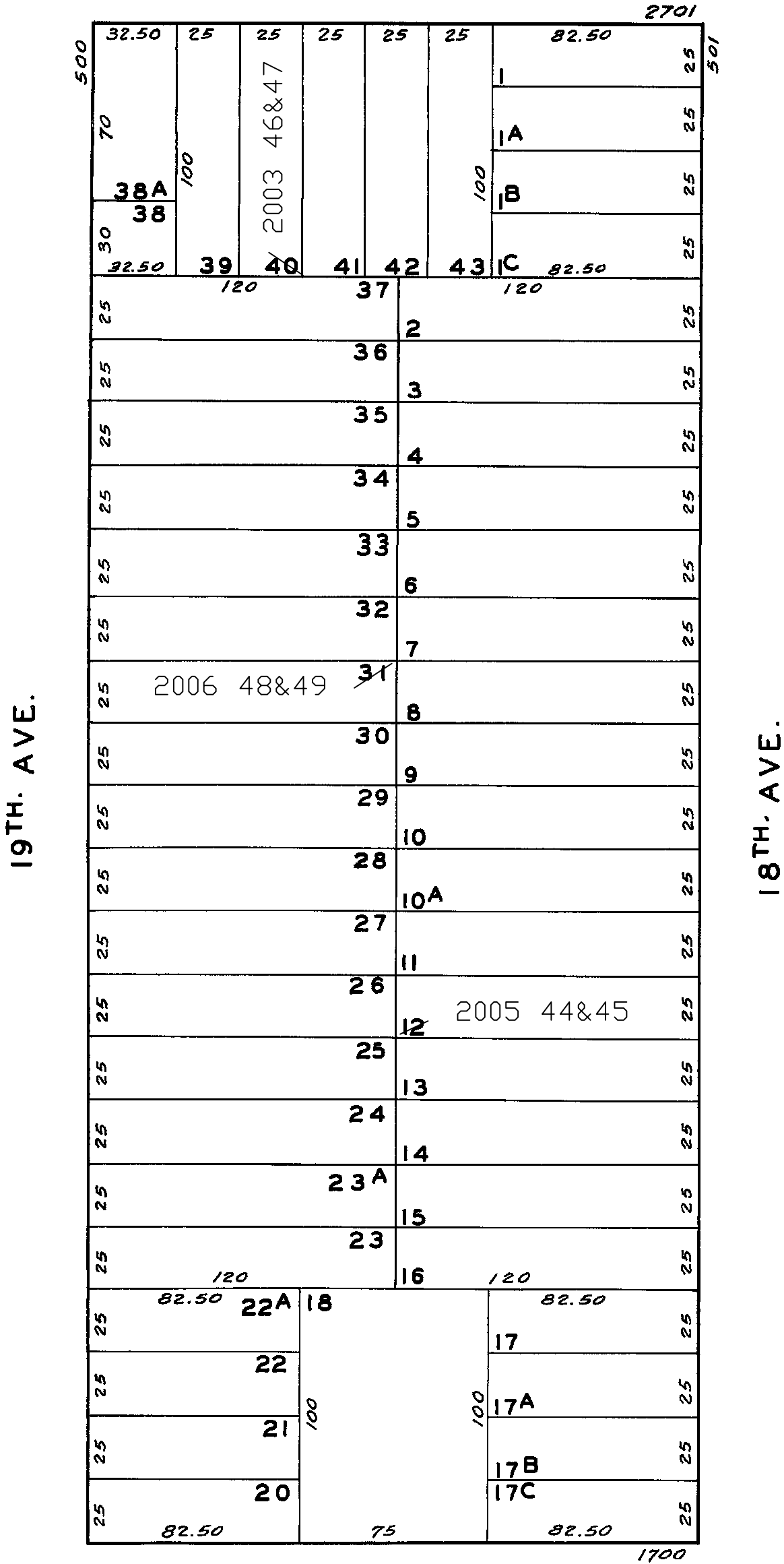

563-565 18TH AVE.			
A CONDOMINIUM			
LOT	UNIT	% COMM.	AREA
44	563	58.5	
45	565	41.5	

2739-2741 ANZA ST.			
A CONDOMINIUM			
LOT	UNIT	% COMM.	AREA
46	2739	50	
47	2741	50	

542 19TH AVE.			
A CONDOMINIUM			
LOT	UNIT	% COMM.	AREA
48	1	51.08	
49	2	48.92	