

LOTS MERGED
LOT 13 INTO LOT 12-1943
" 38 " " 37-"
" 41 " " 40-"
lot31 into lots107&108 for 2001 roll
lot65 into lots111to113 for 2004 roll
lot25 into lots109&110 for 2004 roll
lot76 into lots117to119 for 2005 roll
lot14 into lots114to116 for 2007 roll
lot24 into lots122&123 for 2009 roll
lot45 into lots128&129 for 2009 roll
lot29 into lots126&127 for 2009 roll
lot49 into lots130/132 for 2010 roll
lot82 into lots124&125 for 2010 roll
lot53 into lots120&121 for 2011 roll
lot55 into lots133&134 for 2011 roll
lot81 into lots135/138 for 2014 roll
Lot 7 into lots 139 & 140 for 2015 roll

110-112 HANCOCK ST.
A CONDOMINIUM

LOT	UNIT	%COMM. AREA
99	110	49.21
100	112	50.79

3970-3972 19TH ST.
A CONDOMINIUM

LOT	UNIT	% COMM. AREA
107	3970	59.00
108	3972	41.00

REVISED 1980
" '85
" '88
Revised 2001
Revised 2004
Revised 2005
Revised 2007
Revised 2009
Revised 2010
Revised 2011
Revised 2014
REVISED 2015

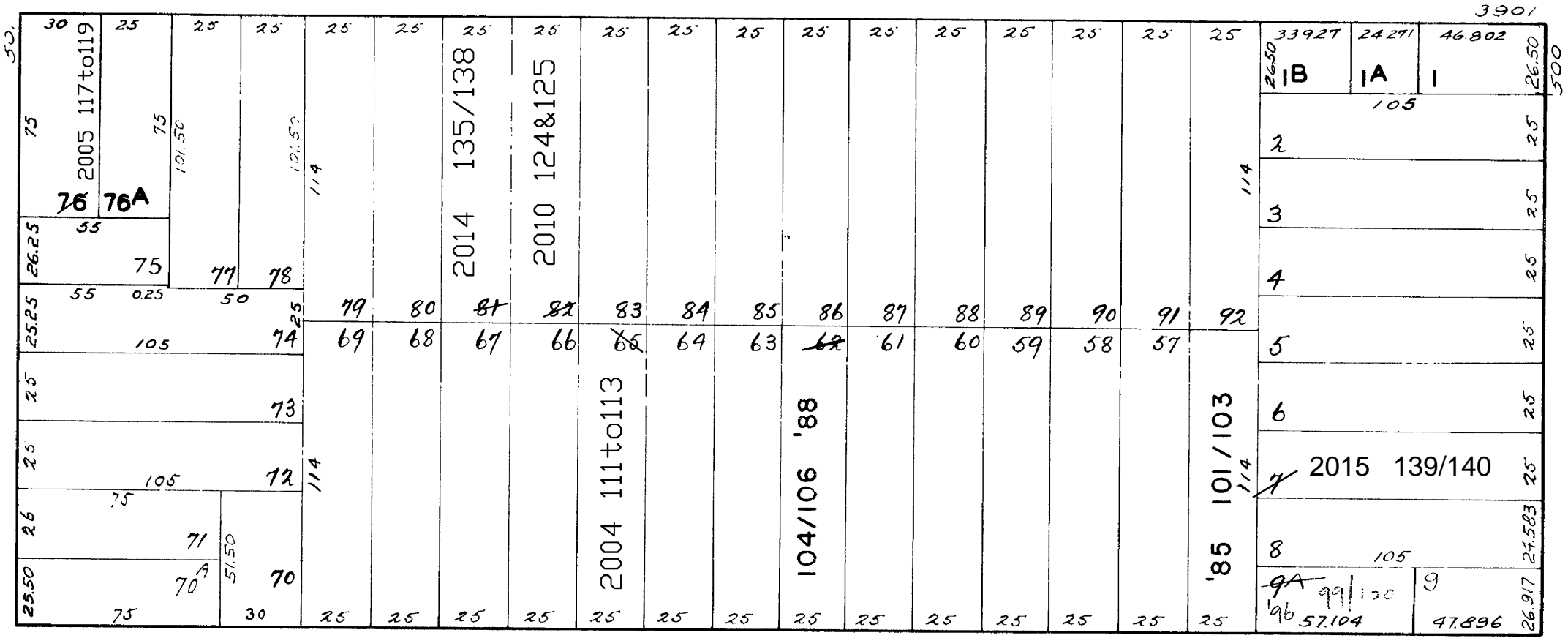

NOE

HANCOCK

SANCHEZ

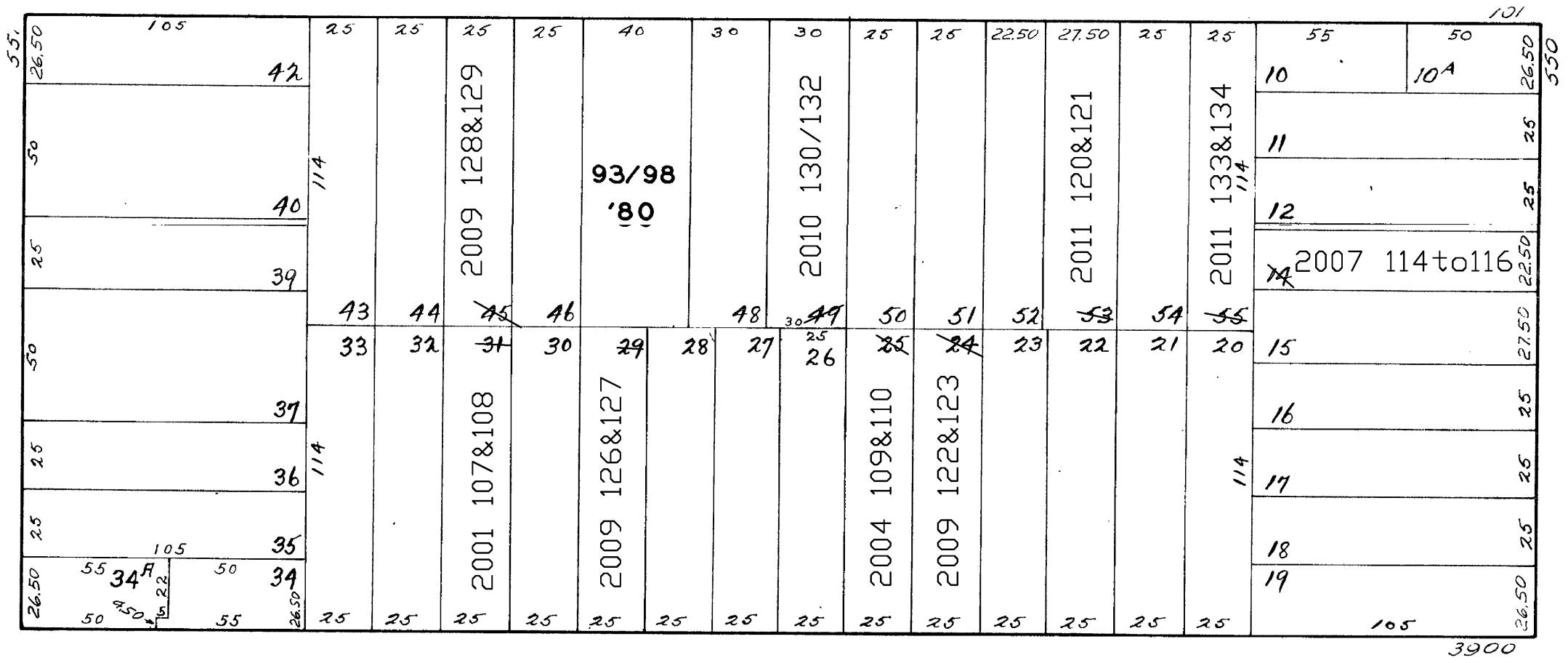

HANCOCK HEIGHTS

A CONDOMINIUM

LOT NO	UNIT NO	% COMMON AREA
93	1	25.00
94	2	16.67
95	3	16.67
96	4	16.67
97	5	16.67
98	6	8.32

19TH

116 - 120 HANCOCK ST.
A CONDOMINIUM

LOT NO.	UNIT NO.	% COMMON AREA
101	116	42.19
102	118	27.44
103	120	30.37

146-150 HANCOCK ST
A CONDOMINIUM

LOT	UNIT	% COMM. AREA
104	146	24.96
105	148	23.61
106	150	51.43

501 NOE ST.
A CONDOMINIUM

LOT	UNIT	% COMM. AREA
117	1	43.29
118	2	27.83
119	3	28.88

160 HANCOCK ST.
A CONDOMINIUM

LOT	UNIT	% COMM. AREA
111	1	31.11
112	2	26.22
113	3	42.67

3942-3944 19TH ST.
A CONDOMINIUM

LOT	UNIT	% COMM. AREA
109	1	47.40
110	2	52.60

566-570 SANCHEZ ST.
A CONDOMINIUM

LOT	UNIT	% COMM. AREA
114	566	15
116	568	10
117	570	75