

lot2 into lots12to15 for 1999 roll
lot16 into lots78&79 for 2002 roll
lot10 into lots158&159 for 2009 roll
lot159 into lots202to236 for 2013 roll
Lot 158 into lots 160 to 201 for 2015 roll

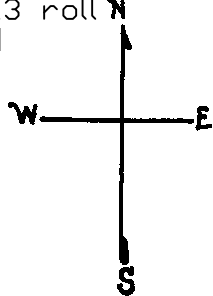

LOTS MERGED
LOTS INTO LOTS
2/7 1 "38"
6A 1 "49"

23RD ST.

lot79 into lots128to157 for 2003 roll
lot78 into lots80to127 for 2003 roll
lot12 into lots18to37 for 2001 roll
lot13 into lots58to77 for 2001 roll
lot14 into lots38to57 for 2002 roll
lots9&11 into lots16&17 for 1999 roll

SHEET 1
4228

NEW POTRERO BLKS. 359 & 36

REVISED '61
REVISED '64

Revised 1999
Revised 2001
Revised 2002
Revised 2003
Revised 2009
Revised 2013
REVISED 2015

INDIANA

MINNESOTA

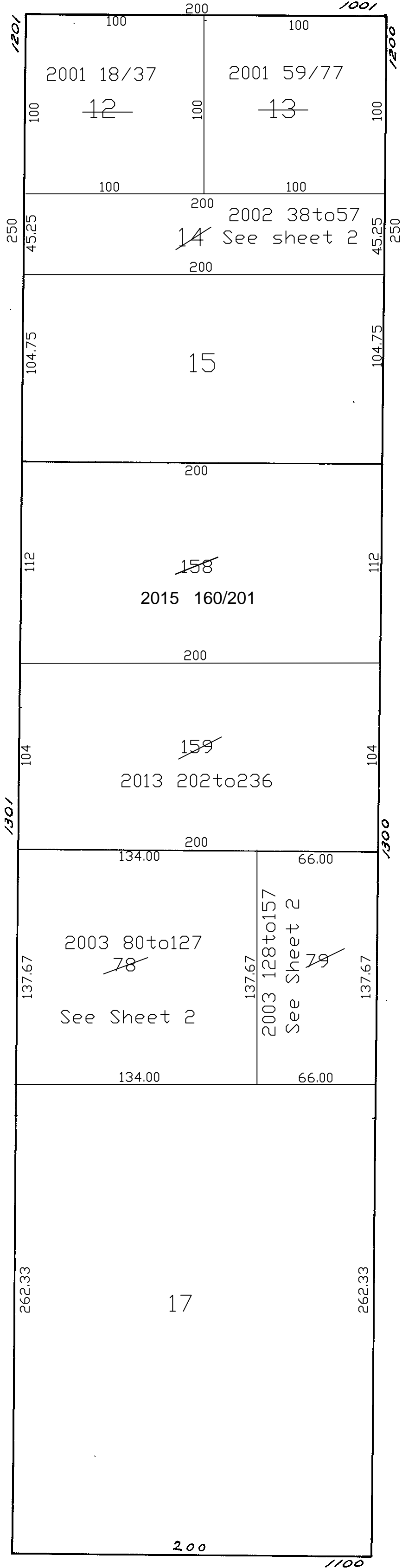

1011 23RD ST. A CONDOMINIUM			
LOT	UNIT	% COMM.	AREA
58	1	3.68	
59	2	4.15	
60	3	3.70	
61	4	5.31	
62	5	3.68	
63	6	5.31	
64	7	5.44	
65	8	3.03	
66	9	3.41	
67	10	2.26	
68	11	6.39	
69	12	5.08	
70	13	6.40	
71	14	5.79	
72	15	6.40	
73	16	5.78	
74	17	9.20	
75	18	5.23	
76	19	5.77	
77	20	3.99	

1099 23RD ST. A CONDOMINIUM			
LOT	UNIT	% COMM.	AREA
18	1	2.30	
19	2	3.40	
20	3	2.99	
21	4	5.30	
22	5	5.46	
23	6	3.72	
24	7	5.46	
25	8	3.72	
26	9	4.20	
27	10	3.66	
28	11	4.00	
29	12	5.73	
30	14	5.29	
31	15	9.28	
32	16	5.75	
33	17	6.35	
34	18	5.76	
35	19	6.35	
36	20	5.00	
37	21	6.28	

25TH ST.

BLOCK 4228

SHEET 2

Revised 2002
Revised 2003

1207 INDIANA ST.
A CONDOMINIUM

LOT	UNIT	% COMM. AREA
38	1	5.03
39	2	4.69
40	3	2.83
41	4	5.97
42	5	5.29
43	6	4.66
44	7	5.32
45	8	2.77
46	9	5.99
47	10	4.66
48	11	5.07
49	12	4.59
50	13	4.94
51	14	6.00
52	15	5.30
53	16	5.35
54	17	5.32
55	18	4.85
56	19	5.93
57	20	5.34

1310 MINNESOTA ST.
A CONDOMINIUM

LOT	UNIT	% COMM. AREA
128	1	3.32
129	2	3.26
130	3	4.01
131	4	3.27
132	5	3.27
133	6	3.09
134	7	3.37
135	8	4.05
136	9	3.33
137	10	3.35
138	11	3.35
139	12	3.29
140	13	3.01
141	14	3.40
142	15	3.38
143	16	3.20
144	17	3.40
145	18	3.01
146	19	3.33
147	20	3.15
148	21	3.39
149	22	3.29
150	23	3.01
151	24	3.46
152	25	3.38
153	26	3.19
154	27	3.49
155	28	3.01
156	29	3.44
157	30	3.40

1325 INDIANA ST.
A CONDOMINIUM

LOT	UNIT	% COMM. AREA
80	1	3.03
81	2	2.67
82	3	2.85
83	4	2.71
84	5	2.37
85	6	2.37
86	7	2.35
87	8	2.36
88	9	2.35
89	10	2.36
90	11	2.24
91	12	2.36
92	13	2.37
93	14	2.37
94	15	1.92
95	16	2.38
96	17	1.85
97	18	1.78
98	19	1.76
99	20	1.66
100	21	1.99
101	22	2.00
102	23	1.98
103	24	1.99
104	25	1.98
105	26	1.99
106	27	1.92
107	28	1.99
108	29	1.99
109	30	2.00
110	31	1.63
111	32	2.00
112	33	1.71
113	34	1.57
114	35	1.53
115	36	1.72
116	37	2.02
117	38	2.02
118	39	2.03
119	40	2.02
120	41	2.02
121	42	2.02
122	43	2.03
123	44	2.02
124	45	2.03
125	46	2.03
126	47	1.69
127	48	2.03