

LOTS MERGED

LOT 15 INTO LOTS 14 & 16 - 1949
LOT 18 INTO LOT 17 - 1955
lot54 into lots52&53 for 2002 roll
lot17 into lots54&55 for 2002 roll
lot19 into lots56&57 for 2003 roll
lot37 into lots58to60 for 2009 roll
lot8 into lots61/63 for 2010 roll
lot11 into lots64&65 for 2011 roll
Lot 4 into lots 66 & 67 for 2016 roll

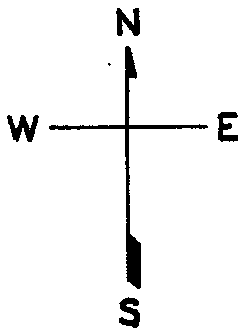

HORNER'S ADD. BLK. 31

REVISED '73
Revised 2002
Revised 2003
Revised 2009
Revised 2010
Revised 2011
REVISED 2016

25TH

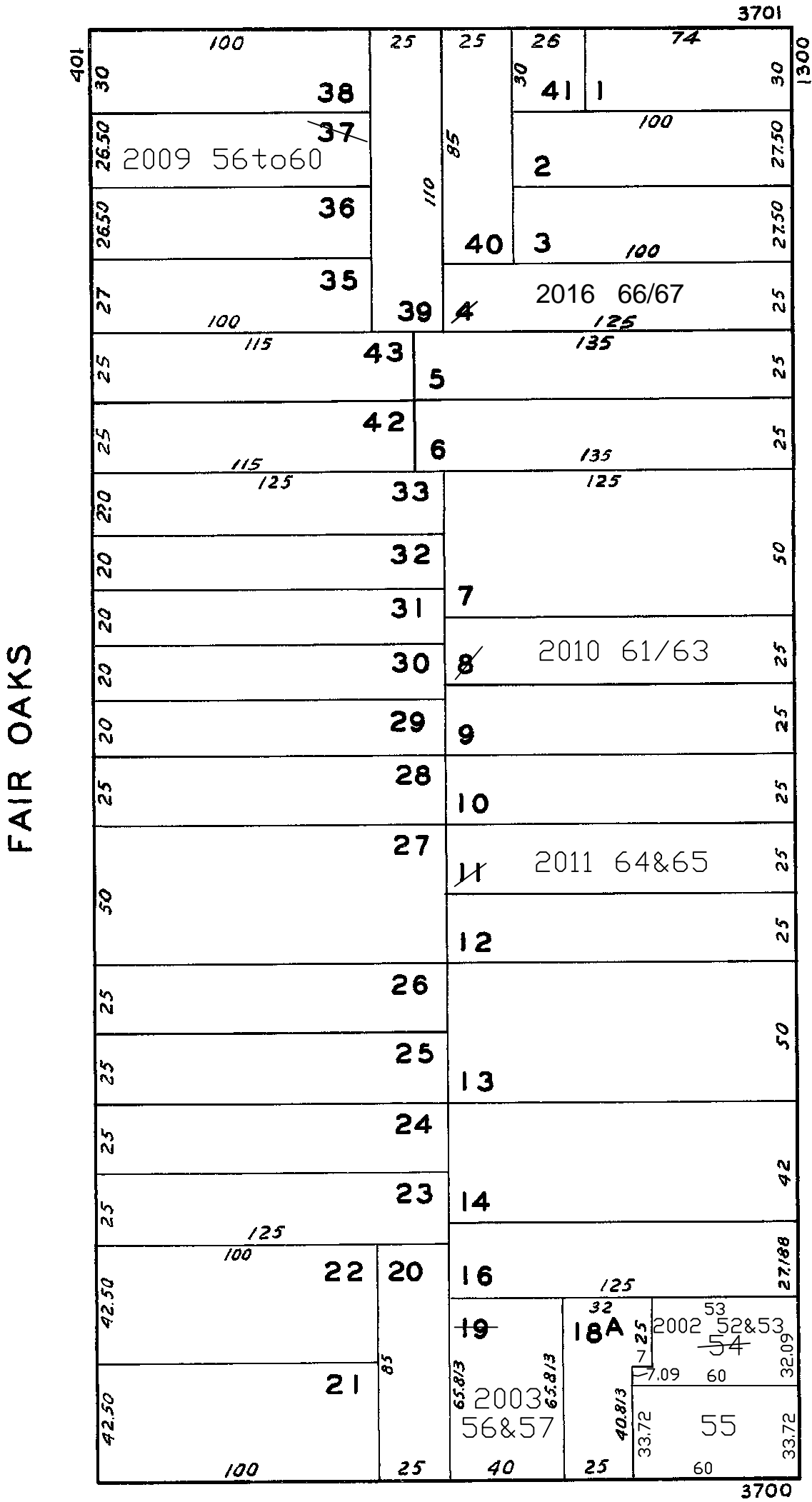

1390 GUERRERO ST.
A CONDOMINIUM

LOT	UNIT	% COMM. AREA
52	1	32.94
53	2	75.48

26TH

3724 26th St.
A CONDOMINIUM

LOT	UNIT	% COMM. AREA
56	1	50
57	2	50