

LOTS MERGED

LOT 21 INTO LOTS 17/20 '1927'  
" 2A " " 28&3 '1941'  
lot 11A into lots 48/50 for 1999 roll  
lot11 into lots51&52 for 2006 roll

© COPYRIGHT SAN FRANCISCO  
CITY & COUNTY ASSESSOR 1995

Lot 51 into lots 65 to 67 for 2017 roll  
Lot 52 into lots 61 to 64 for 2017 roll

OLD 50 VARA BLK 261

REVISED '75  
REVISED 1976  
Revised 1978  
Revised 1979  
REVISED 1981  
" '83  
" '90  
Revised 1999  
Revised 2006  
REVISED 2017

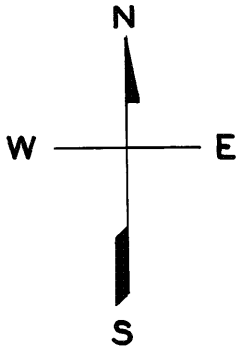

780-782-784 BAY ST.  
A CONDOMINIUM

| LOT | UNIT | % COMM. AREA |
|-----|------|--------------|
| 48  | 782  | 35.58        |
| 49  | 780  | 39.92        |
| 50  | 784  | 24.50        |

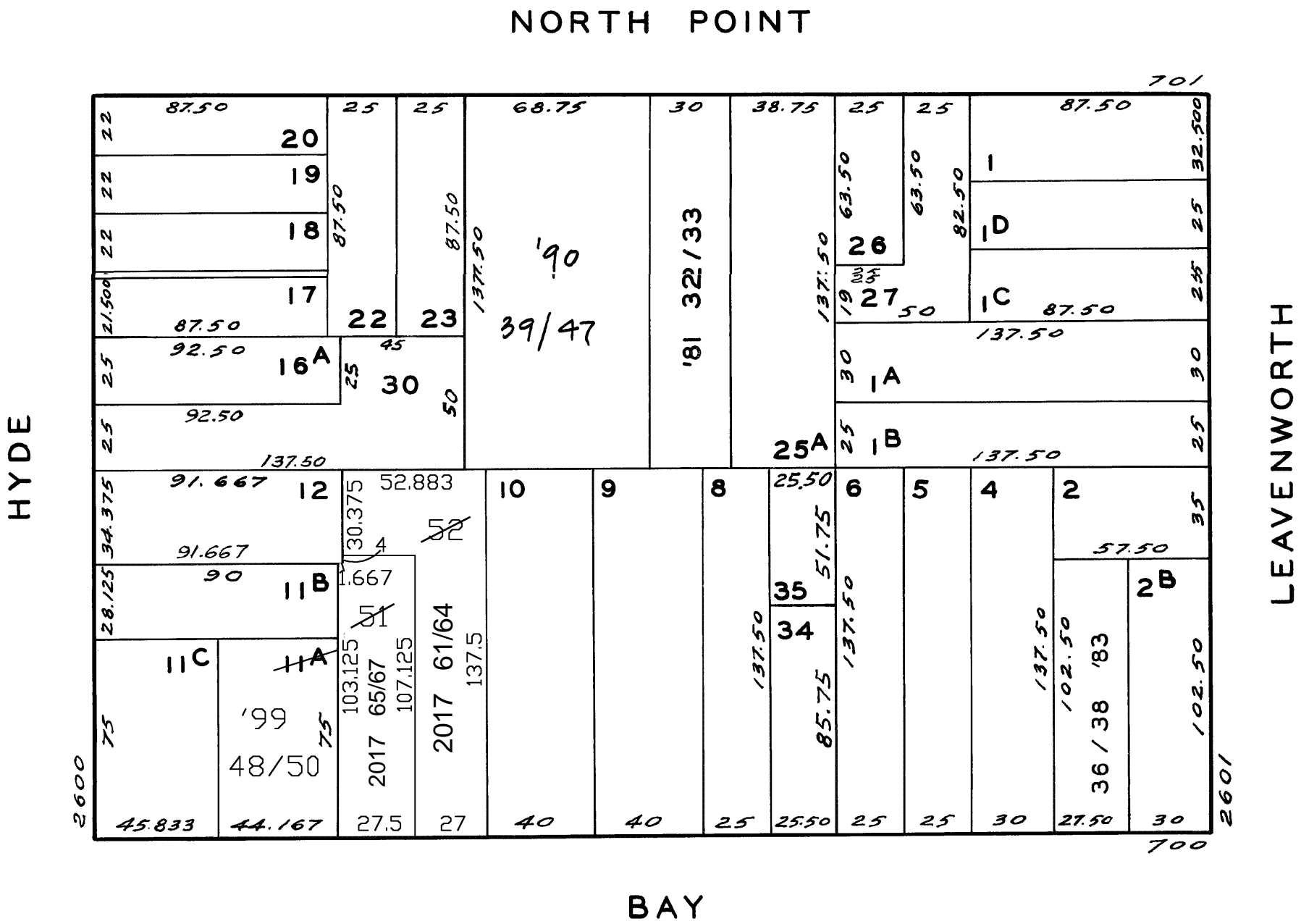

757 NORTH POINT ST.  
A CONDOMINIUM

| LOT | UNIT | % COMM. AREA |
|-----|------|--------------|
| 39  | 1    | 14.81        |
| 40  | 2    | 10.33        |
| 41  | 3    | 10.43        |
| 42  | 4    | 9.34         |
| 43  | 5    | 10.31        |
| 44  | 6    | 11.56        |
| 45  | 7    | 12.55        |
| 46  | 8    | 10.10        |
| 47  | 9    | 10.57        |

747 NORTH POINT ST.  
A CONDOMINIUM

| LOT NO. | UNIT NO. | % COMMON AREA |
|---------|----------|---------------|
| 32      | 1        | 50            |
| 33      | 2        | 50            |

708-712 BAY ST.  
A CONDOMINIUM

| LOT | UNIT | % COMM AREA |
|-----|------|-------------|
| 36  | 708  | 29.640      |
| 37  | 710  | 32.838      |
| 38  | 712  | 37.522      |