

W A BLK. 670

REVISED	1979
"	'81
"	'83
"	'85
"	'86
"	'88
"	'89

Revised 2002  
Revised 2005  
Revised 2008  
Revised 2014  
**REVISED 2017**

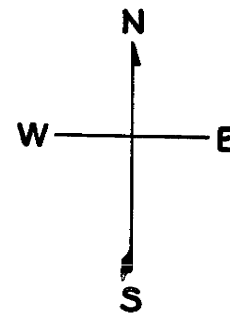

GROVE

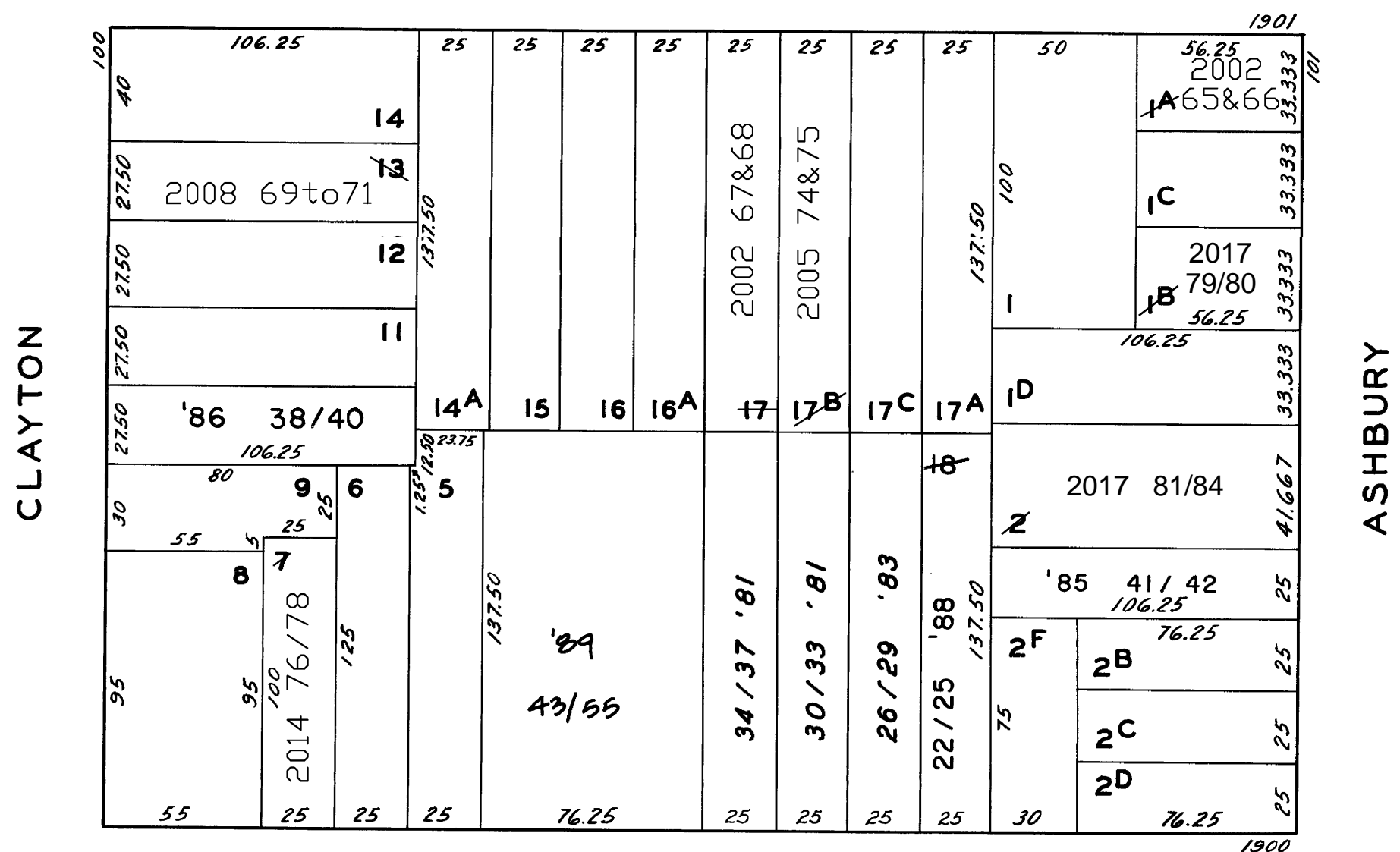

HAYES

## CONDOMINIUMS

<u>CONDOMINIUMS</u>	<u>LOT NO.</u>	<u>UNIT NO.</u>	<u>% COMMON AREA</u>
	22	1	25.35
<u>1924 HAYES ST</u>	23	2	24.65
	24	3	25.35
	25	4	24.65
	26	1	25.690
	27	2	24.310
<u>1930 HAYES ST.</u>	28	3	25.690
	29	4	24.310
	30	1	25.510
<u>1940 HAYES ST.</u>	31	2	24.490
	32	3	25.510
	33	4	24.490
	34	1	25.350
<u>1950 HAYES ST.</u>	35	2	24.650
	36	3	25.350
	37	4	24.650
<u>143 ASHBURY ST.</u>	41	L	50
	42	U	50

<u>110-114 CLAYTON ST.</u>	
<u>LOT</u>	<u>UNIT</u>
69	110
70	112
71	114

<u>101-103 ASHBURY ST.</u>		
<u>A CONDOMINIUM</u>		
<u>LOT</u>	<u>UNIT</u>	<u>% COMM. AREA</u>
65	101	47.08
66	103	52.92

<u>1941-1943 Grove St.</u>		
<u>A CONDOMINIUM</u>		
<u>LOT</u>	<u>UNIT</u>	<u>% COMM. AREA</u>
74	1941	53
75	1943	47