

© COPYRIGHT SAN FRANCISCO
CITY & COUNTY ASSESSOR 1995

lot8 into lots59&60 for 1999 roll
lot10 into lots61&62 for 2003 roll
lot5 into lots48to51 for 2006 roll
lot2 into lots63to65 for 2007 roll
lot43 into lots66&67 for 2010 roll
lot31 into lots 68&69 for 2011 roll
lot37 into lots70&71 for 2014 roll
Lot 44 into lots 72 to 74 for 2016 roll
Lot 33 into lots 75 to 77 for 2018 roll

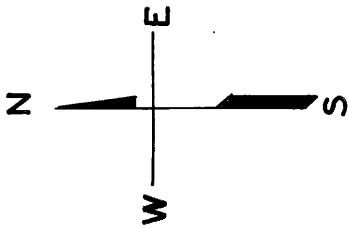

HORNERS ADDN. BLK. 159

REVISED 1993
" '94
" '95
Revised 1999
Revised 2003
Revised 2006
Revised 2007
Revised 2010
Revised 2011
Revised 2014
REVISED 2016
REVISED 2018

NOE

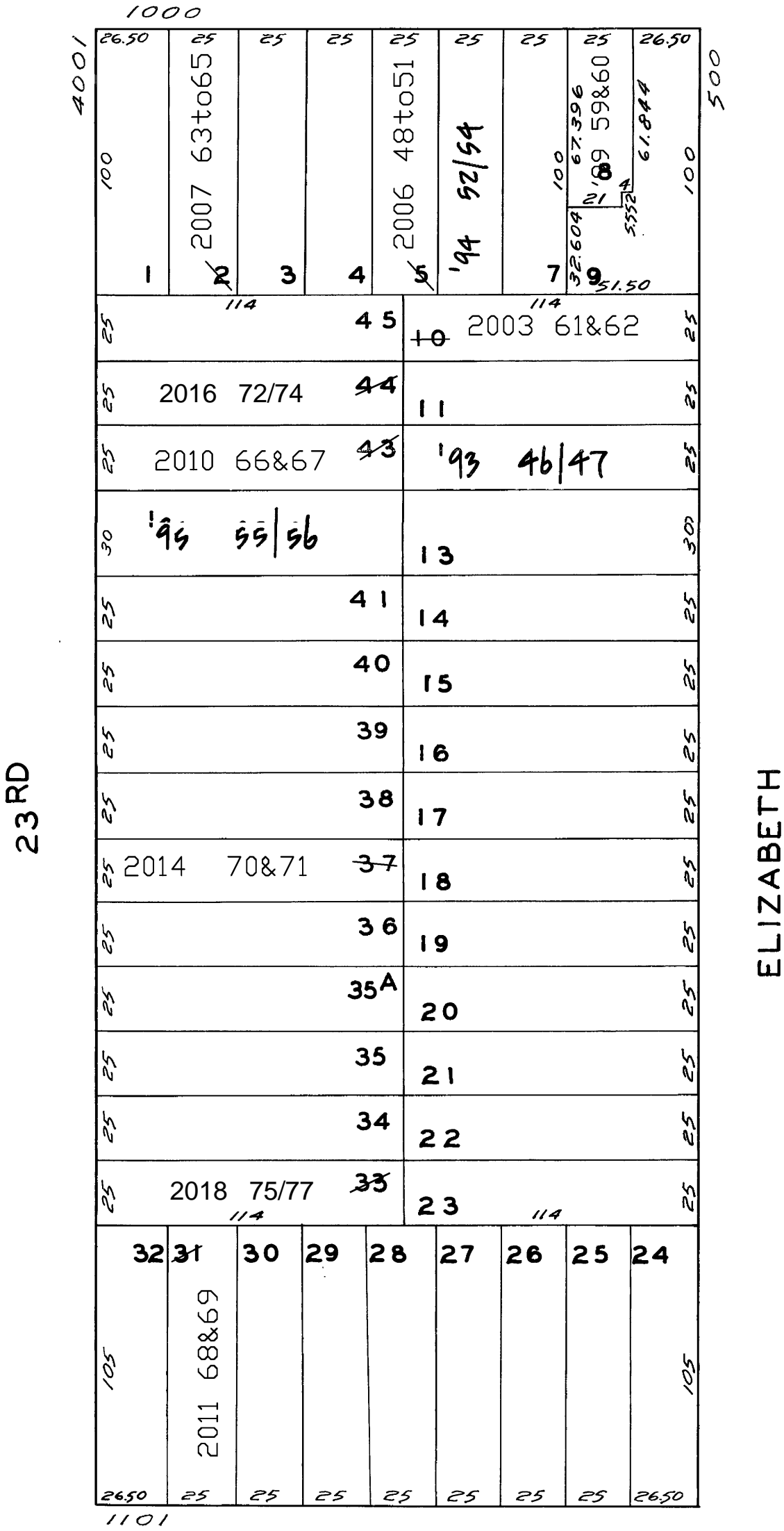

CASTRO

1016-1020 NOE ST.			
A CONDOMINIUM			
LOT	UNIT	% COMM.	AREA
48	1016A	12.82	
49	1016B	19.69	
50	1018	50.73	
51	1020	16.76	

1038-1040 NOE ST.			
A CONDOMINIUM			
LOT	UNIT	% COMM.	AREA
59	1038	40.0	
60	1040	60.0	

4037-4039 23RD ST.			
A CONDOMINIUM			
LOT	UNIT	% COMM.	AREA
55	4037	50	
56	4039	50	

524-526 ELIZABETH ST.			
A CONDOMINIUM			
LOT	UNIT	% COMM.	AREA
46	526	45.26	
47	524	54.74	

1026-28-30 NOE ST.			
A CONDOMINIUM			
LOT	UNIT	% COMM.	AREA
52	1030	29.46	
53	1028	33.74	
54	1026	36.80	

3623-3625 19TH ST.			
A CONDOMINIUM			
LOT	UNIT	% COMM.	AREA
61	512	61.4	
62	514	38.6	

1006 NOE ST.			
A CONDOMINIUM			
LOT	UNIT	% COMM.	AREA
63	1	33.33	
64	2	33.33	
65	3	33.34	