

© COPYRIGHT SAN FRANCISCO  
 CITY & COUNTY ASSESSOR 1995  
 lot53 into lots58&59 for 2007 roll  
 lot51 into lots60&61 for 2014 roll  
 Lot 35 into lots 62 to 65 for 2017 roll  
 Lot 56 into lots 66 & 67 for 2017 roll

6603

HORNER'S ADD  
 BLK 168

REVISED '59  
 REVISED '63  
 " '66  
 " '71  
 " '72  
 Revised 2007  
 Revised 2014  
 REVISED 2017

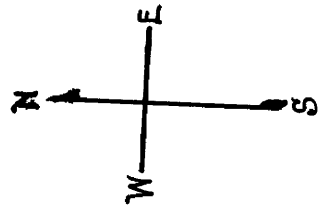

NOE

DUNCAN

28TH

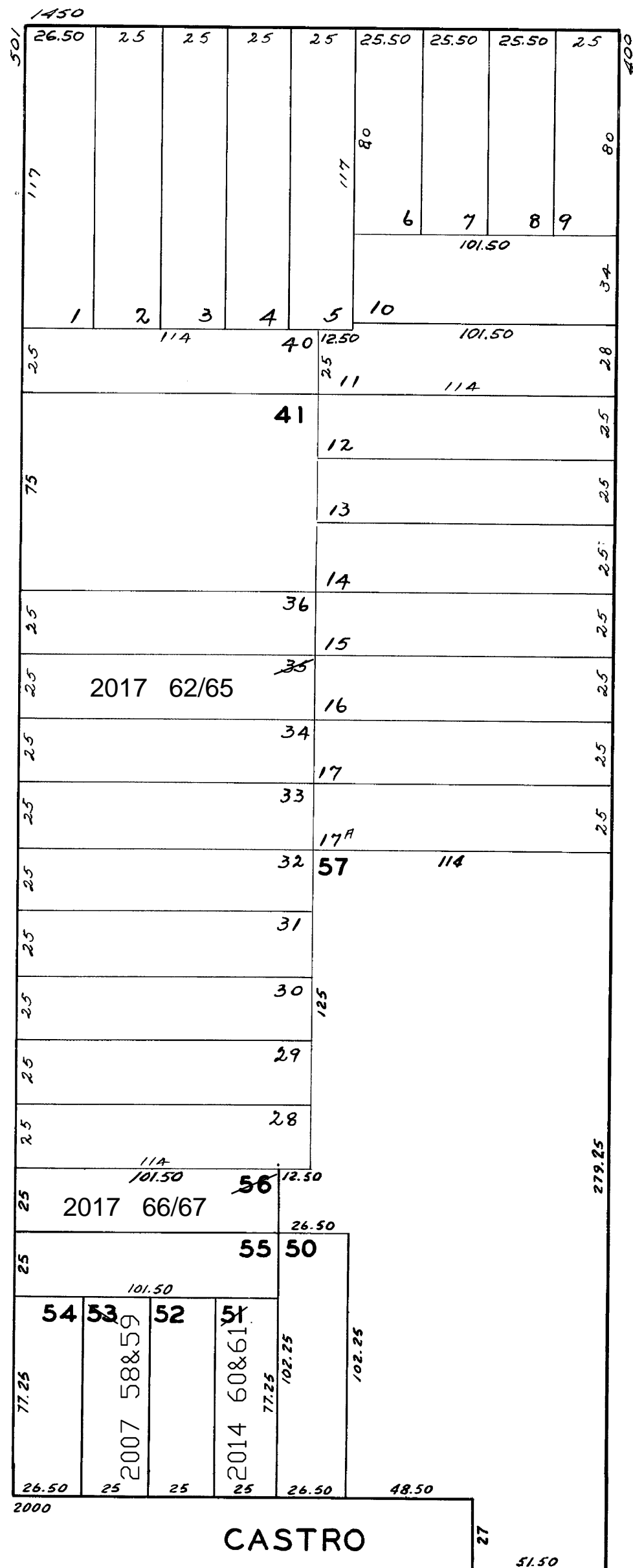

CASTRO

2007-2009 CASTRO ST.			
A CONDOMINIUM			
LOT	UNIT	% COMM.	AREA
58	2007	50	
59	2009	50	