

LOTS MERGED
 LOT 2 INTO LOT 1-1948
 " 5 " " 4-1951
 lot6 into lots14to16 for 2010 roll

50 VARA BLK 175

Revised 2010

© COPYRIGHT SAN FRANCISCO
 CITY & COUNTY ASSESSOR 1995

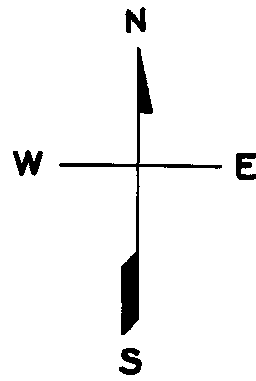

NORTH POINT

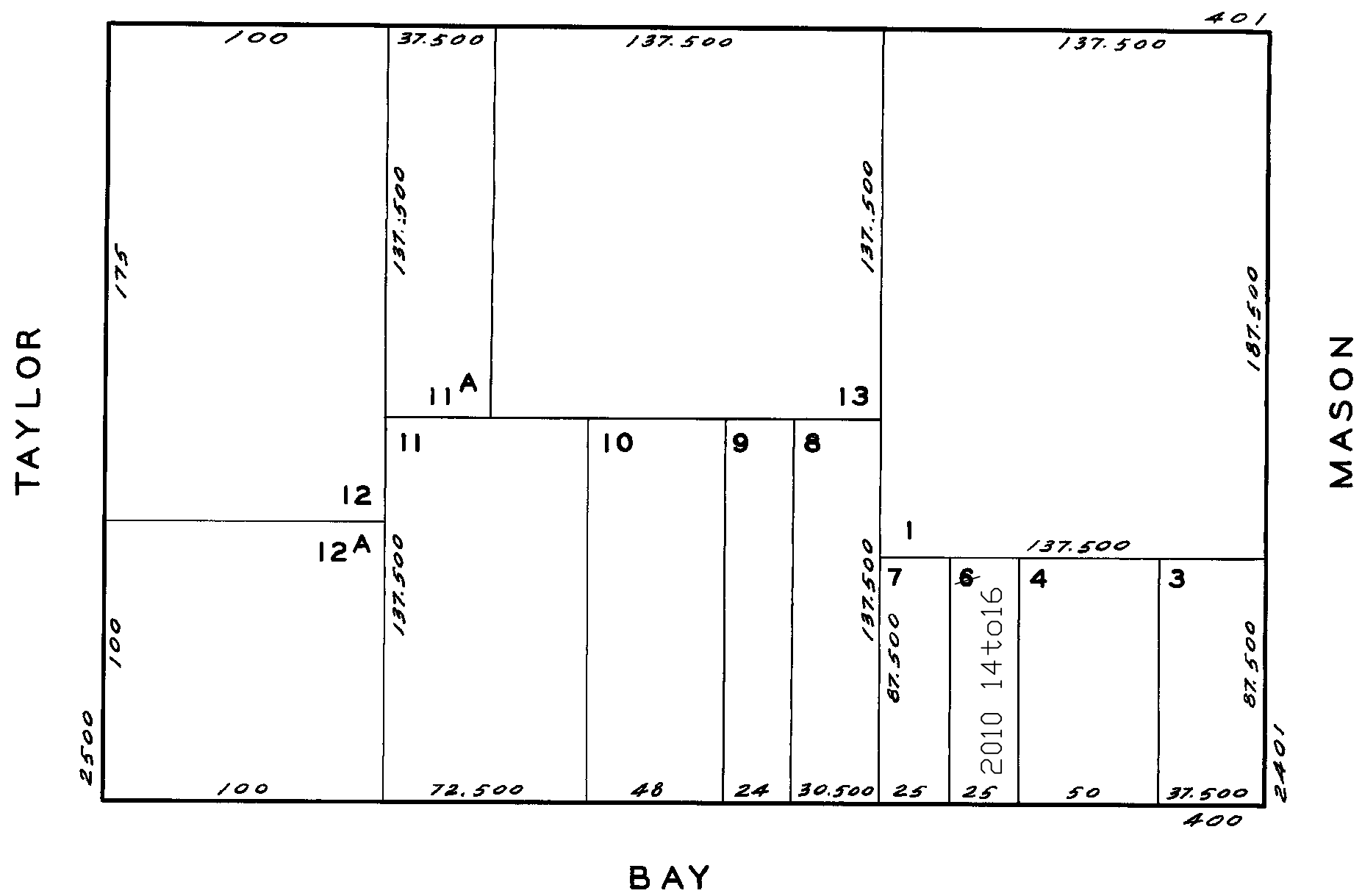

ASSESSED 113,438 SQ. FT.
 BLK. TOTAL 113,438 SQ. FT.