

W A BLK. 257
MARINA GARDENS

REVISED 1984
" '91
" '94

Revised 2000
Revised 2004
Revised 2014

Lot 13A-14A Merged into 1A "41"
" 13B " " 16 "45"
1 34/43 '84
29 30/33 '84

lot 15 into lots 57&58 for 2000 roll
lots2&3 into lot44 for 2004 roll
lot44 into lots47to49 for 2004 roll
lot21 into lots71&72 for 2014 roll

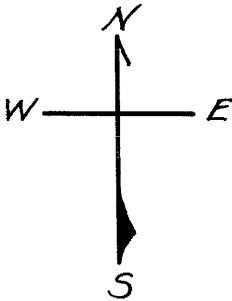

BEACH

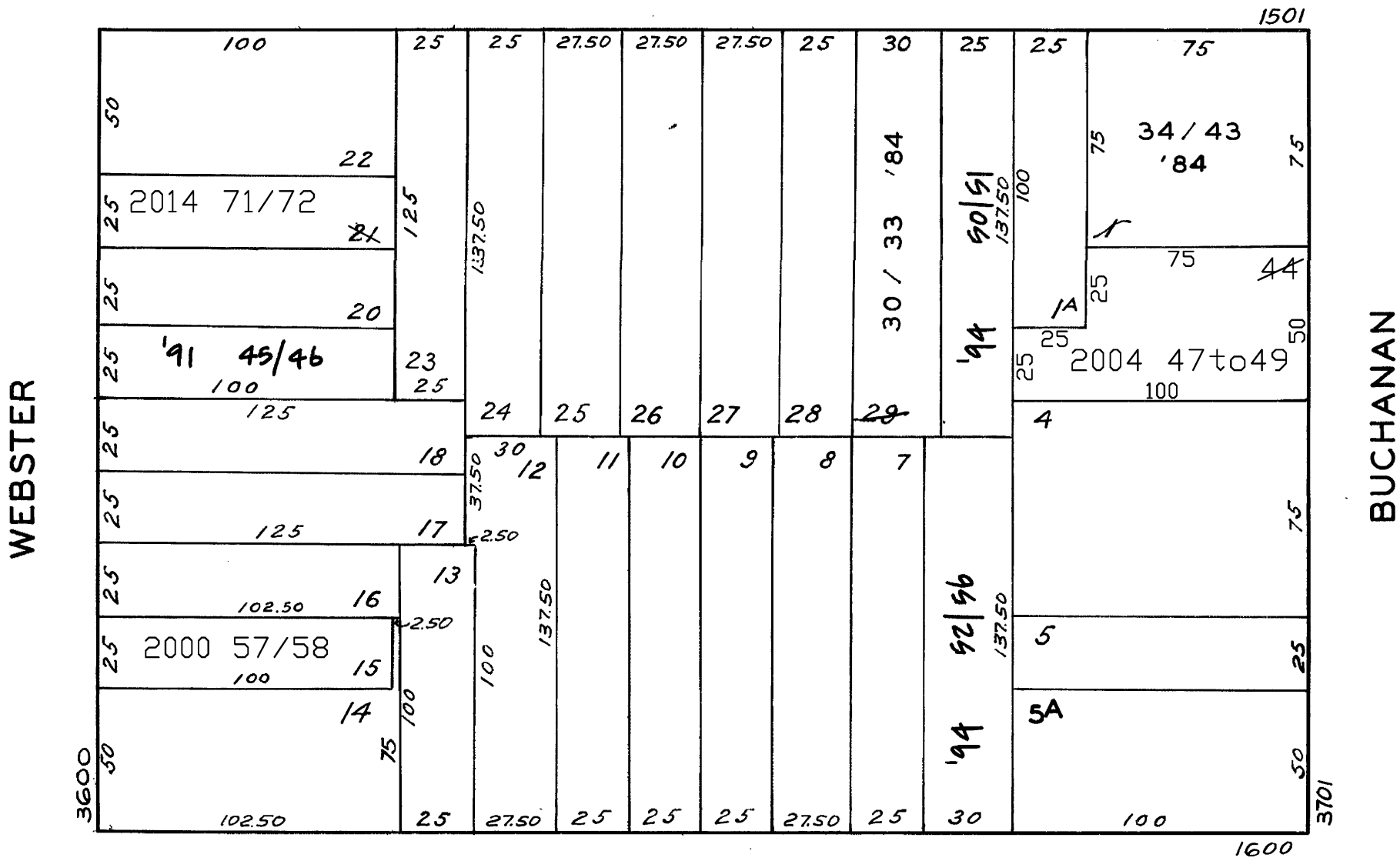

NORTH POINT

1626 NORTH POINT ST.			1529-31-33 BEACH ST.			1501 BEACH ST.			3612-3614 WEBSTER ST.		
A CONDOMINIUM			A CONDOMINIUM			A CONDOMINIUM			A CONDOMINIUM		
LOT	UNIT	% COMM. AREA	LOT	UNIT	COMM. AREA	LOT	UNIT	COMM. AREA	LOT	UNIT	% COMM. AREA
92	101	21.41	30	1	11.62	34	101	7.229	57	3612	63.70
93	102	23.65	31	2	32.02	35	102	6.634	58	3614	36.30
94	105	9.88	32	3	33.91	36	103	13.250			
95	201	21.41	33	4	22.45	37	201	8.209			
96	202	23.65				38	202	6.650			
						39	203	9.110			
						40	301	11.577			
						41	302	12.882			
						42	401	11.577			
						43	402	12.882			

3636 - 3638 WEBSTER ST.			1929-1927 BEACH ST.		
A CONDOMINIUM			A CONDOMINIUM		
LOT	UNIT	% COMM. AREA	LOT	UNIT	% COMM. AREA
45	3636	53.50	90	1929	99.30
46	3638	46.50	91	1927	44.70

3741 BUCHANAN ST.		
A CONDOMINIUM		
LOT	UNIT	% COMM. AREA
47	1	42
48	2	37
49	3	21