

634

LOTS MERGED

Lots
23 merged into lot 22 1944
1A merged into lot 2 1956

lot13 into lots 39&40 for 1999 roll
lot11 into lots35&36 for 2001 roll
lot19 into lots43to45 for 2006 roll
Lot 32 into lots 51 to 53 for 2016 roll
Lot 6 into lots 54 to 57 for 2016 roll

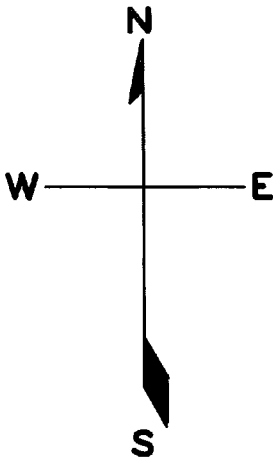

W.A. BLK. 390

REVISED	1963
"	1971
"	'84
"	'96

Revised 1999
Revised 2000
Revised 2001
Revised 2006
REVISED 2016

SACRAMENTO

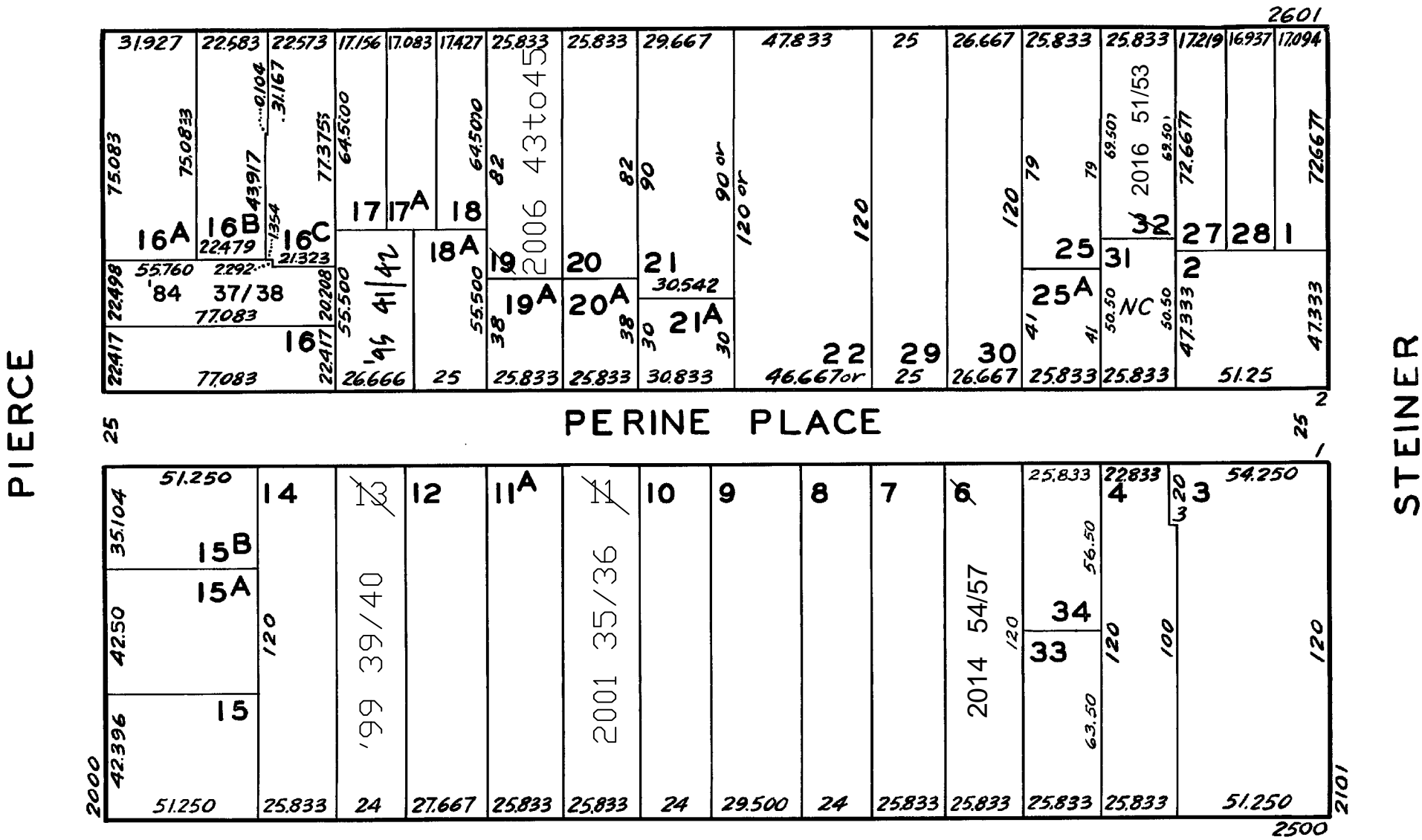

CALIFORNIA

2032-2034 PIERCE ST.

A CONDOMINIUM

LOT NO.	UNIT NO.	% COMMON AREA
---------	----------	---------------

37	2032	31.610
38	2034	68.390

74-76 PERINE PLACE

A CONDOMINIUM

LOT	UNIT	% COMM AREA
41	76	48.84
42	74	51.16

2558-2560 CALIFORNIA STREET

A CONDOMINIUM

LOT	UNIT	% COMM. AREA
35	2558	29.604
36	2560	70.396

2578-2580 CALIFORNIA STREET

A CONDOMINIUM

LOT	UNIT	% COMM. AREA
39	2578	46.40
40	2580	53.60

2663-2667 SACRAMENTO ST.

A CONDOMINIUM

LOT	UNIT	% COMM. AREA
43	2663	48.75
44	2665	24.56
45	2667	26.69