

Lot 2 merged into lot 1 - 1933
Lots 18A + 19A merged into lot 19 - 1943

W A BLK.159

664

N	REVISED	157
	"	172
	"	78
	"	81
	"	84
	"	88
	"	90
	"	91

OCTAVIA

GOUGH

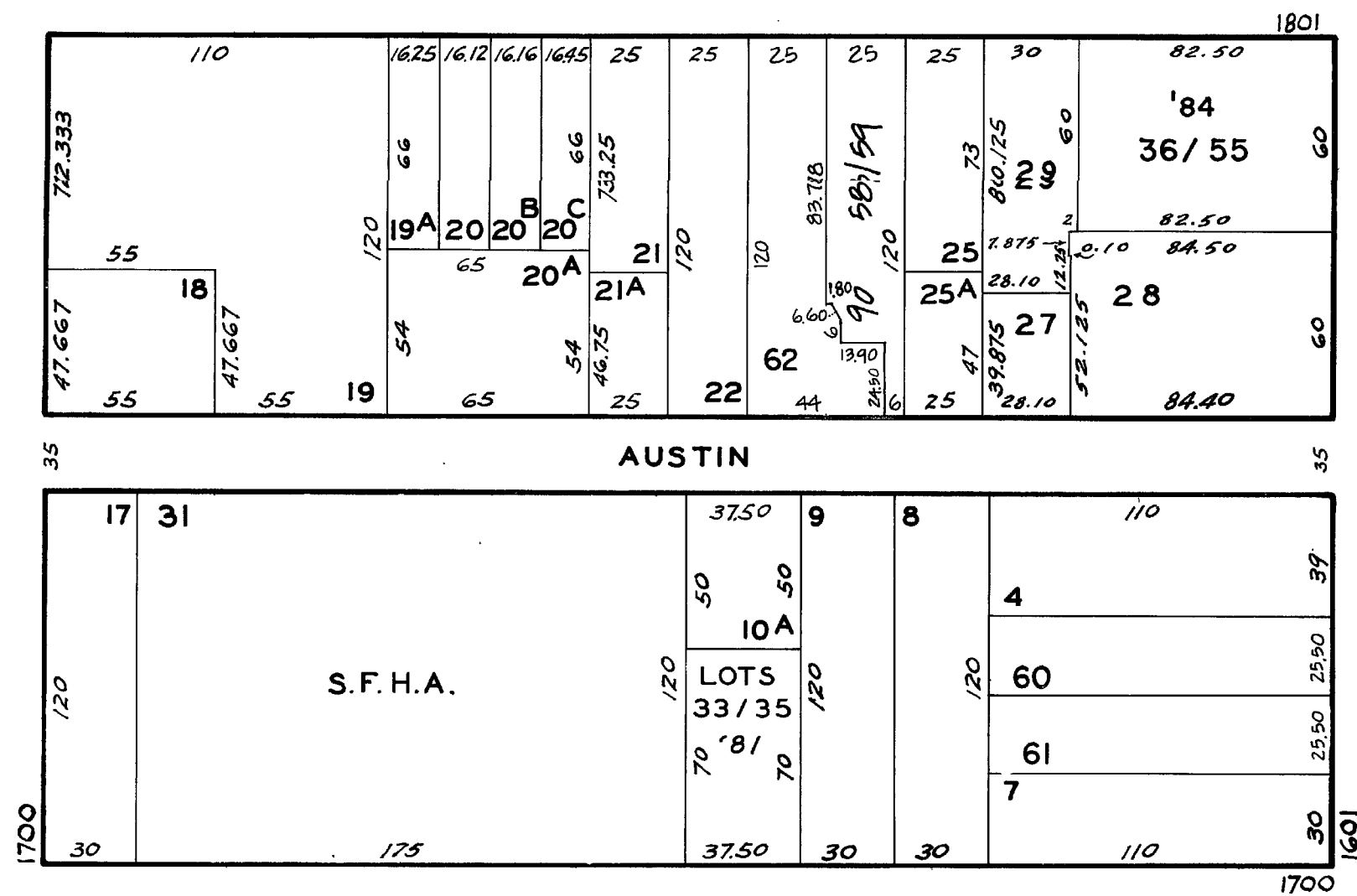

1805 PINE ST.

1738-1742 BUSH ST.

<u>LOT NO.</u>	<u>UNIT NO.</u>	<u>% COMMON AREA</u>
33	1	37.75
34	2	30.38
35	3	31.87

LOT	UNIT	% COMM. AREA
58	100	51.55
59	200	48.45

LOT NO.	UNIT NO.	% COMMON AREA
36	36	4.339
37	37	4.055
38	1	3.865
39	2	4.117
40	3	5.250
41	4	18.240
42	5	4.259
43	6	4.055
44	21	3.865
45	22	4.117
46	23	4.781
47	24	3.761
48	25	5.189
49	26	4.339
50	27	4.055
51	31	3.865
52	32	4.117
53	33	4.781
54	34	3.761
55	35	5.189