

ASSESSOR-RECORDER'S OFFICE

© COPYRIGHT SAN FRANCISCO  
CITY & COUNTY ASSESSOR 1995

922

LOTS		MERGED	
LOT	28	INTO	LOT 29-1933
"	10	"	" 9-1944
"	14	"	" 13-
"	16	"	" 15-
"	32	"	" 31-

W A BLK. 4 8 5

REVISED 1985

lot19 into lots48&49 for 1999 roll  
lot2 into lots50&51 for 2003 roll

Revised '99  
Revised 2003

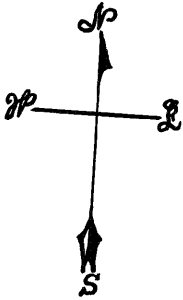

NORTH POINT

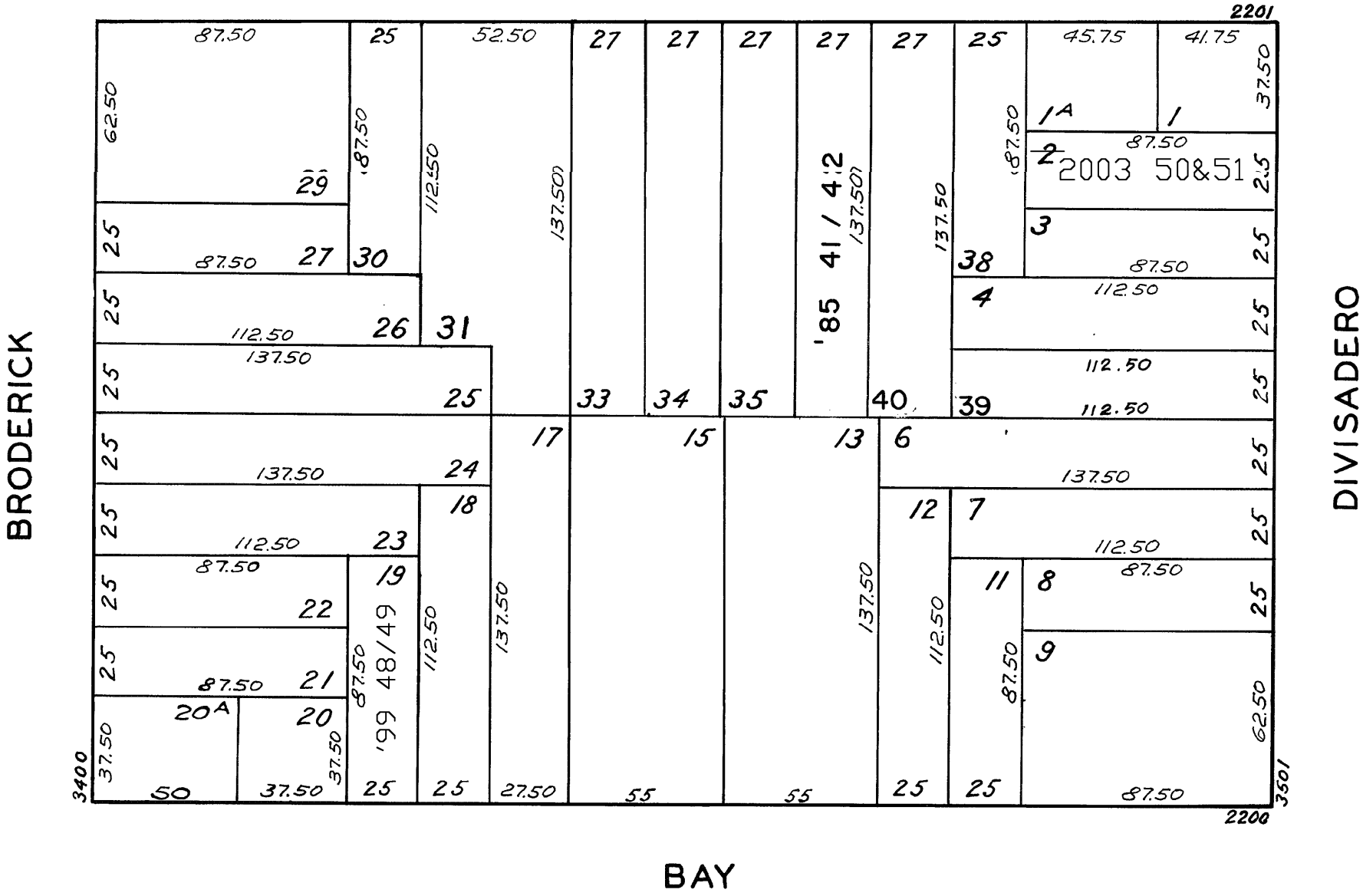

2223- 2225 NORTH POINT ST.  
A CONDOMINIUM

LOT NO.	UNIT NO.	% COMMON AREA
41	1	48.62
42	2	51.38

2272-2274 BAY STREET  
A CONDOMINIUM

LOT	UNIT	% COMM. AREA
48	2272	47.5
49	2274	52.5

3553-3555 DIVISADERO ST.  
A CONDOMINIUM

LOT	UNIT	% COMM. AREA
50	3553	58.2
51	3555	41.8