

LOTS MERGED

Lot 23 merged into lot 22-44
 " 25A " " 25-51"
 lot15 into lots83to85 for 1998 roll
 lot10to12 into lots82 for 2002 roll
 lot9 into lots 91/93 for 2014 roll

© COPYRIGHT SAN FRANCISCO
 CITY & COUNTY ASSESSOR 1995

W A BLK. 497 **980**

REVISED 1959
 REVISED 1960
 REVISED 1979
 REVISED 1980
 REVISED 1981
 " '82
 " '88
 Revised 1998
 Revised 2002
 Revised 2014

2875 JACKSON ST.		
A CONDOMINIUM		
LOT NO.	UNIT NO.	% COMMON AREA
49	1	17.590
50	2	15.742
51	3	17.591
52	4	15.743
53	5	17.591
54	6	15.743

2855 JACKSON ST		
A CONDOMINIUM		
LOT	UNIT	%COMM.AREA
76	101	4.493
77	102	19.841
78	201	19.434
79	202	18.399
80	301	19.434
81	302	18.399

*FOR TAXATION SEGREGATION ONLY

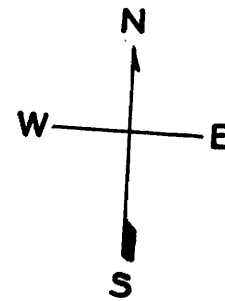

JACKSON

BRODERICK

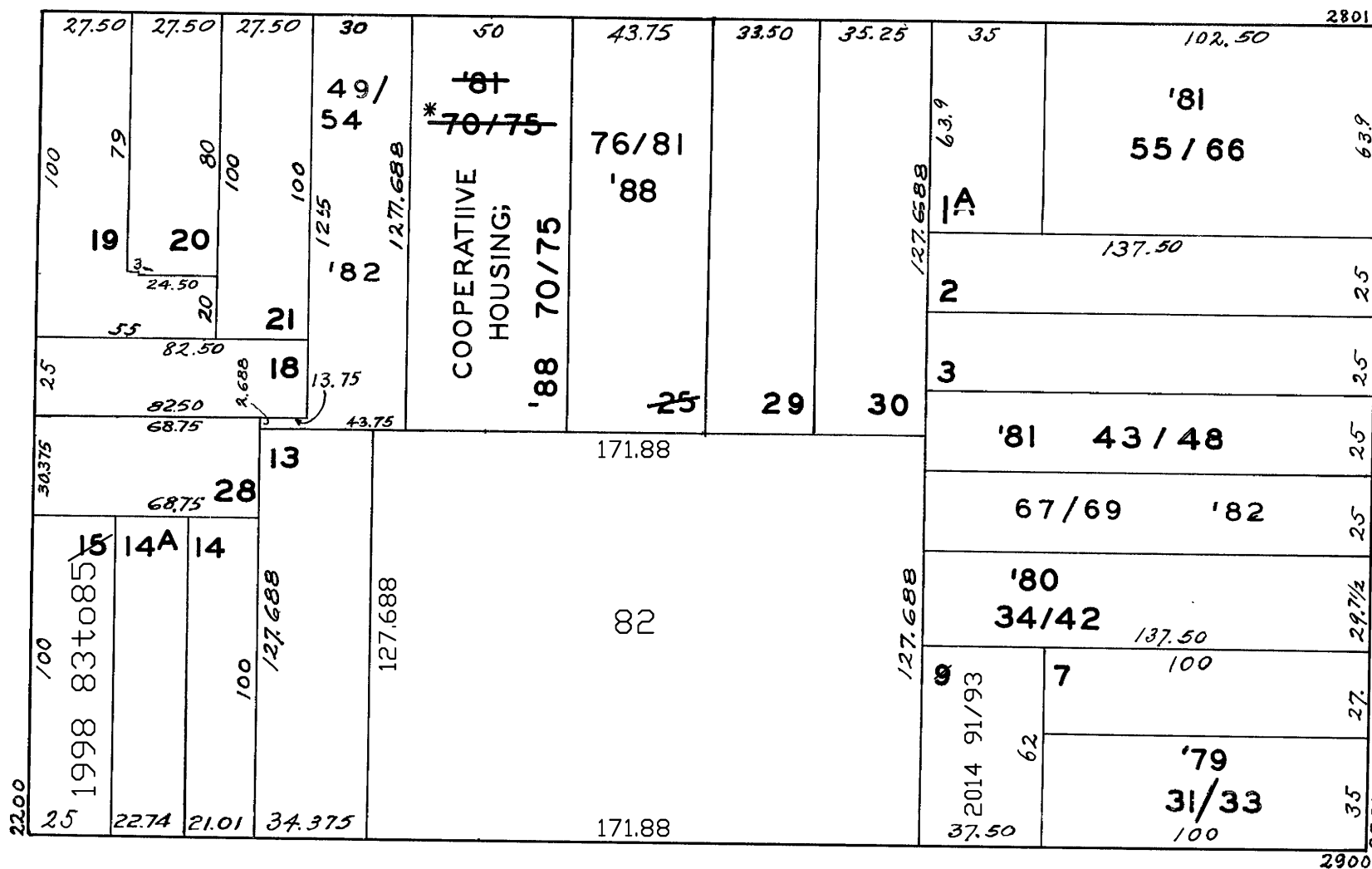

DIVISADERO

2323-25-27 DIVISADERO ST.		
A CONDOMINIUM		
LOT NO.	UNIT NO.	% COMMON AREA
67	2323	34
68	2325	31
69	2327	35

WASHINGTON

2315 DIVISADERO ST.		
A CONDOMINIUM		
LOT NO.	UNIT NO.	% COMMON AREA
34	A	12.759
35	B	6.794
36	C	13.780
37	M	12.759
38	N	6.794
39	O	13.780
40	S	12.759
41	T	6.795
42	U	13.780

2900 WASHINGTON		
A CONDOMINIUM PROJECT		
LOT NO.	UNIT NO.	%COMMON AREA
31	3	31.94
32	2	33.39
33	1	34.67

2801 JACKSON ST.
A CONDOMINIUM

LOT NO.	UNIT NO.	% COMMON AREA
55	1	8.136
56	2	8.238
57	3	7.918
58	4	7.512
59	5	8.034
60	6	7.512
61	7	9.171
62	8	9.381
63	9	8.034
64	10	7.512
65	11	9.171
66	12	9.381

2865 JACKSON ST.		
A CONDOMINIUM		
LOT	UNIT	% COMM. AREA
70	1	15.9
71	2	15.7
72	3	17.2
73	4	17.0
74	5	17.2
75	6	17.0

(LOTS 70/75 FORMERLY CO-OP)

2329 DIVISADERO ST.
A CONDOMINIUM

LOT NO.	UNIT NO.	% COMMON AREA
43	1	13.454
44	2	17.392
45	3	19.032
46	4	15.777
47	5	19.032
48	6	15.313

2994-2996-2998 WASHINGTON ST.		
A CONDOMINIUM		
LOT	UNIT	% COMM. AREA
83	2998	28.14
84	2996	36.39
85	2994	35.47