

PALM TREE GARDENS
1355-1357-1359-1365 & 1375 SCOTT ST.

1100
W A BLK 454

LOTS MERGED
LOTS INTO LOT

18 17 '1944'
37-38-39 36 '1944'
63 65/82 1981
51 95/96 '83
54&55 89/94 '84



49-47 BEIDEMAN ST.

A CONDOMINIUM		
LOT	UNIT	% COMM. AREA
118	46	39.41
119	47	64.59

A CONDOMINIUM		
LOT	UNIT	% COMM. AREA
97	1355	11.89
98	1357	11.83
99	1359	12.03
100	1375	12.21
101	1	8.34
102	2	8.99
103	3	8.69
104	4	8.34
105	5	8.99
106	6	8.69

REVISED '57
REVISED '60
" '75
" '77
" '79
" '80
" '81
" '83
" '84
" '90
" '93

REVISED '99
" '95

1331-1333-1335 SCOTT ST.

A CONDOMINIUM		
LOT	UNIT	% COMM. AREA
120	1331	33.33
121	1333	33.34
122	1335	33.33

O'FARRELL

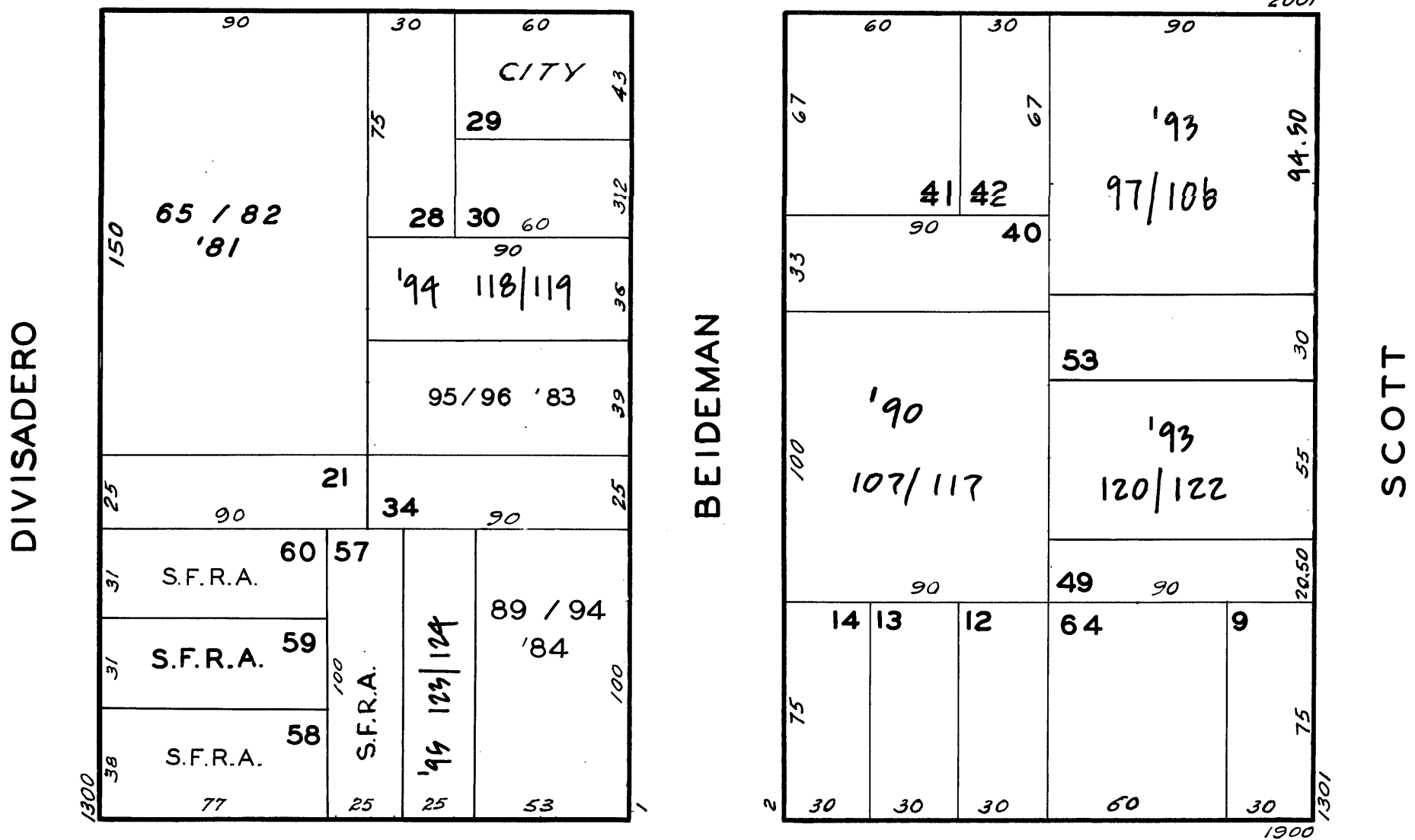

1350 DIVISADERO ST.

A CONDOMINIUM		
LOT NO.	UNIT NO.	% COMMON AREA
65	201	4.782
66	202	4.807
67	203	6.932
68	204	4.807
69	205	4.873
70	206	4.807
71	207	4.784
72	208	7.116
73	209	7.092
74	301	4.782
75	302	4.807
76	303	6.932
77	304	4.807
78	305	4.873
79	306	4.807
80	307	4.784
81	308	7.116
82	309	7.092

33-35 BEIDEMAN ST.

A CONDOMINIUM		
LOT	UNIT	% COMM AREA
95	33	46.775
96	35	53.225

1960-70 ELLIS ST.

A CONDOMINIUM		
LOT	UNIT	% COMM AREA
89	1960	20
90	1962	19
91	1964	16
92	1966	17
93	1968	15
94	1970	13

20-36 BEIDEMAN ST.

A CONDOMINIUM		
LOT	UNIT	% COMM. AREA
107	101	9.23
108	102	9.23
109	103	9.23
110	104	9.23
111	105	9.23
112	201	8.96
113	202	8.96
114	203	8.96
115	204	8.96
116	205	8.96
117	206	8.96

1980-1982 ELLIS ST

A CONDOMINIUM		
LOT	UNIT	% COMM AREA
123	1980	50
124	1982	50