

ASSESSOR-RECORDER'S OFFICE

© COPYRIGHT SAN FRANCISCO
CITY & COUNTY ASSESSOR 1995

1125
W A BLK 533

LOTS MERGED
LOTS INTO LOT

lot9 into lots12/15 for 2002 roll
lot8A into lots18&19 for 2009 roll
Lot 2 into lots 23 & 24 for 2016 roll
Lot 2A into lots 34 to 37 for 2017 roll

Revised '94
Revised 2002
Revised 2009
REVISED 2016
REVISED 2017

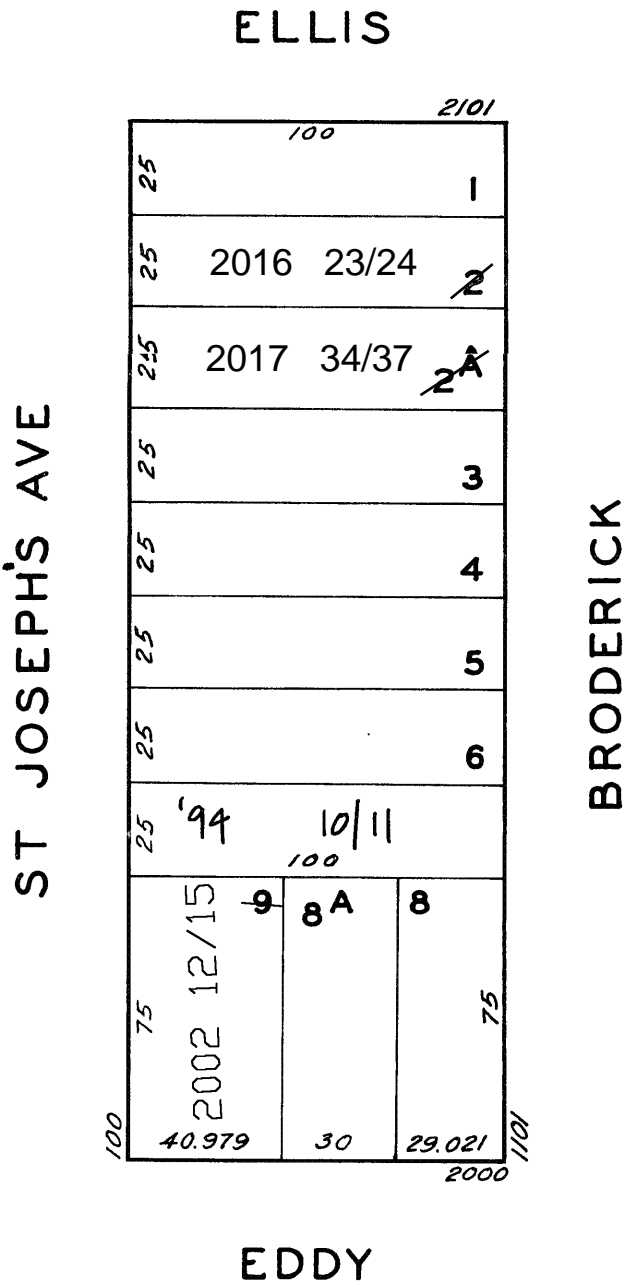
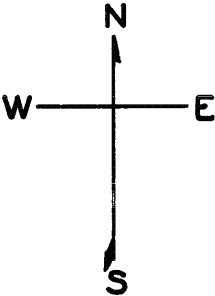

1119 - 1121 BRODERICK ST.

A CONDOMINIUM

LOT	UNIT	% COMM. AREA
10	1119	44
11	1121	56

2010 EDDY ST.

A CONDOMINIUM

LOT	UNIT	% COMM. AREA
12	A	35.38
13	B	8.18
14	C	23.69
15	D	32.75