

Lots 12 merged into lots 10 & 11 "1925"

© COPYRIGHT SAN FRANCISCO
CITY & COUNTY ASSESSOR 1995

lot19 into lots31&32 for 2009 roll
lot30 into lots33&34 for 2010 roll

1601

RICHMOND BLK. 338

REVISED '63

Revised 2009
Revised 2010

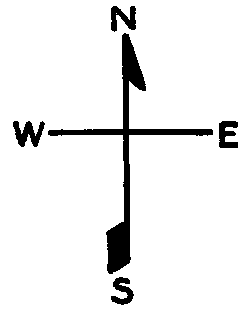

BALBOA

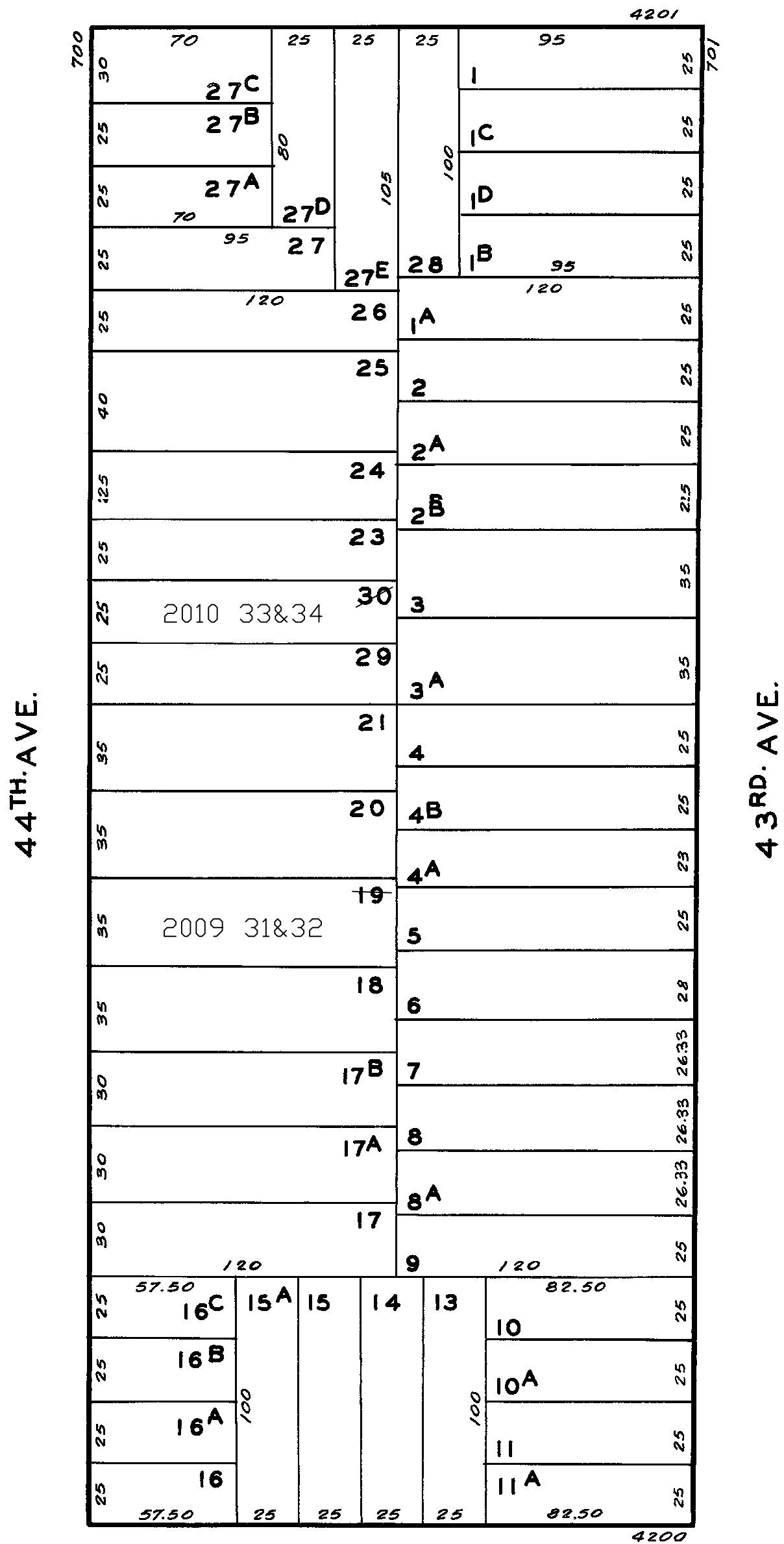

CABRILLO