

ASSESSOR-RECORDER'S OFFICE

© COPYRIGHT SAN FRANCISCO
CITY & COUNTY ASSESSOR 1995

LOTS MERGED
LOT 15 INTO LOT 14-1950
lot7 into lots51/53 for 2001 roll

1649
RICHMOND BLK. 386
REVISED 1983
Revised 2001

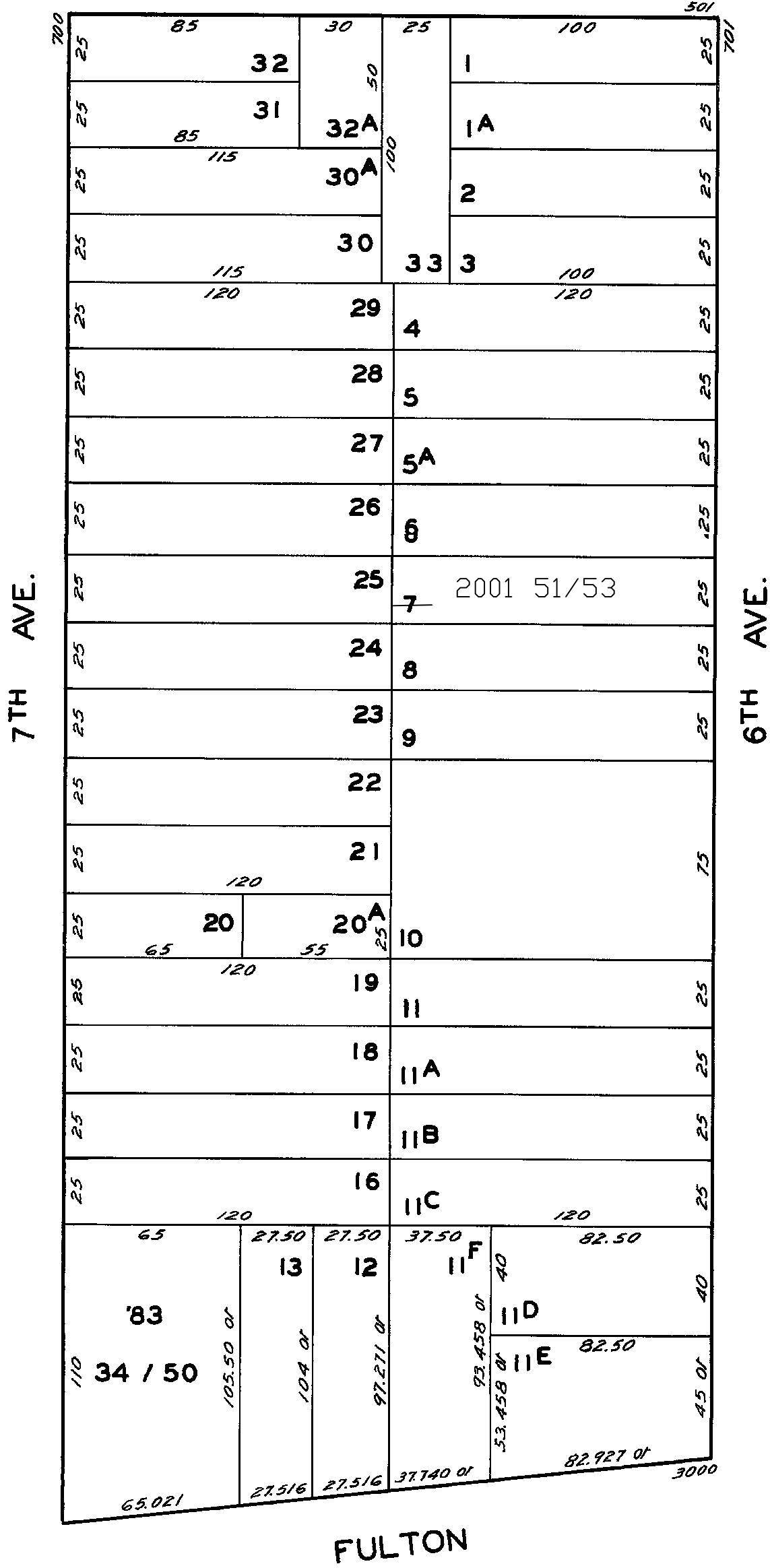
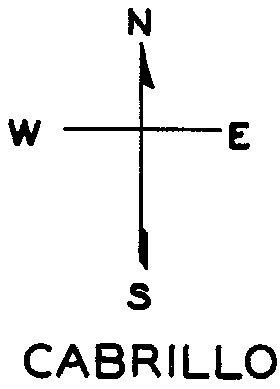

790 SEVENTH AVE.		
A CONDOMINIUM		
LOT NO.	UNIT NO.	%COMMON AREA
34	101	6.25
35	102	5.75
36	103	3.00
37	104	3.50
38	105	4.50
39	201	6.50
40	202	6.33
41	203	6.33
42	204	6.50
43	301	6.50
44	302	6.33
45	303	6.33
46	304	6.50
47	401	6.50
48	402	6.33
49	403	6.33
50	404	6.50

737 6TH AVE.		
A CONDOMINIUM		
LOT	UNIT	% COMM. AREA
51	1	18.74
52	2	36.08
53	3	45.18