

LOTS MERGED

Lots	into	Lot	19-
2-43	"	1	46

REVISED '57  
" '95

Revised 2003  
Revised 2008  
Revised 2009  
Revised 2010  
**REVISED 2015**

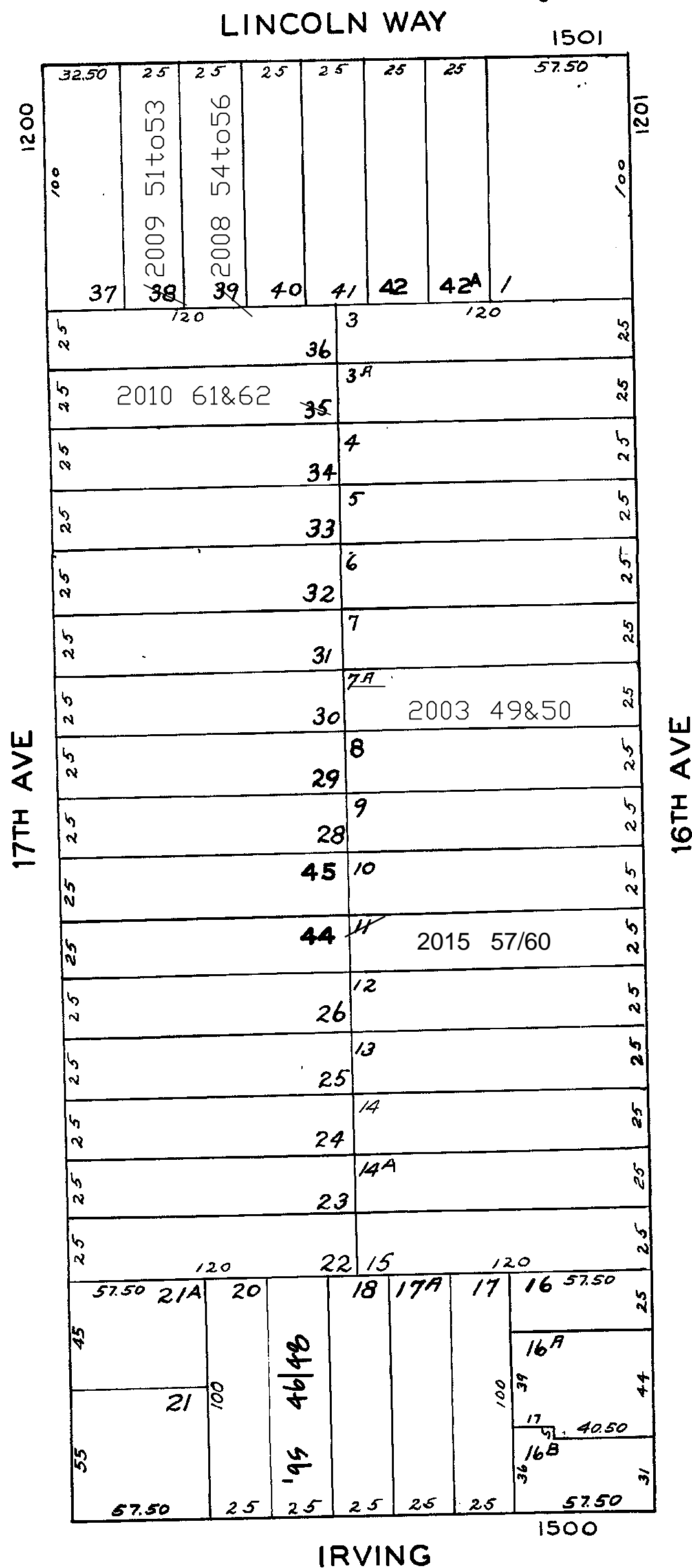

<u>1243-1245 16TH AVE.</u>	
<u>A CONDOMINIUM</u>	
<u>LOT</u>	<u>UNIT % COMM. AREA</u>
49	1243 47.1
50	1245 52.9

1534 IRVING ST.  
A CONDOMINIUM

<u>LOT</u>	<u>UNIT</u>	<u>% COMM. AREA</u>
46	101	23.36
47	102	22.86
48	201	53.78