

ASSESSOR-RECORDER'S OFFICE

© COPYRIGHT SAN FRANCISCO  
CITY & COUNTY ASSESSOR 1995

lot31 into lots37 & 38 for 2001 roll  
lot38 into lots39/41 for 2001 roll  
lot37 into lots42/44 for 2001 roll

1822  
SUNSET BLK. 738

REVISED '60  
" '73

Revised 2001

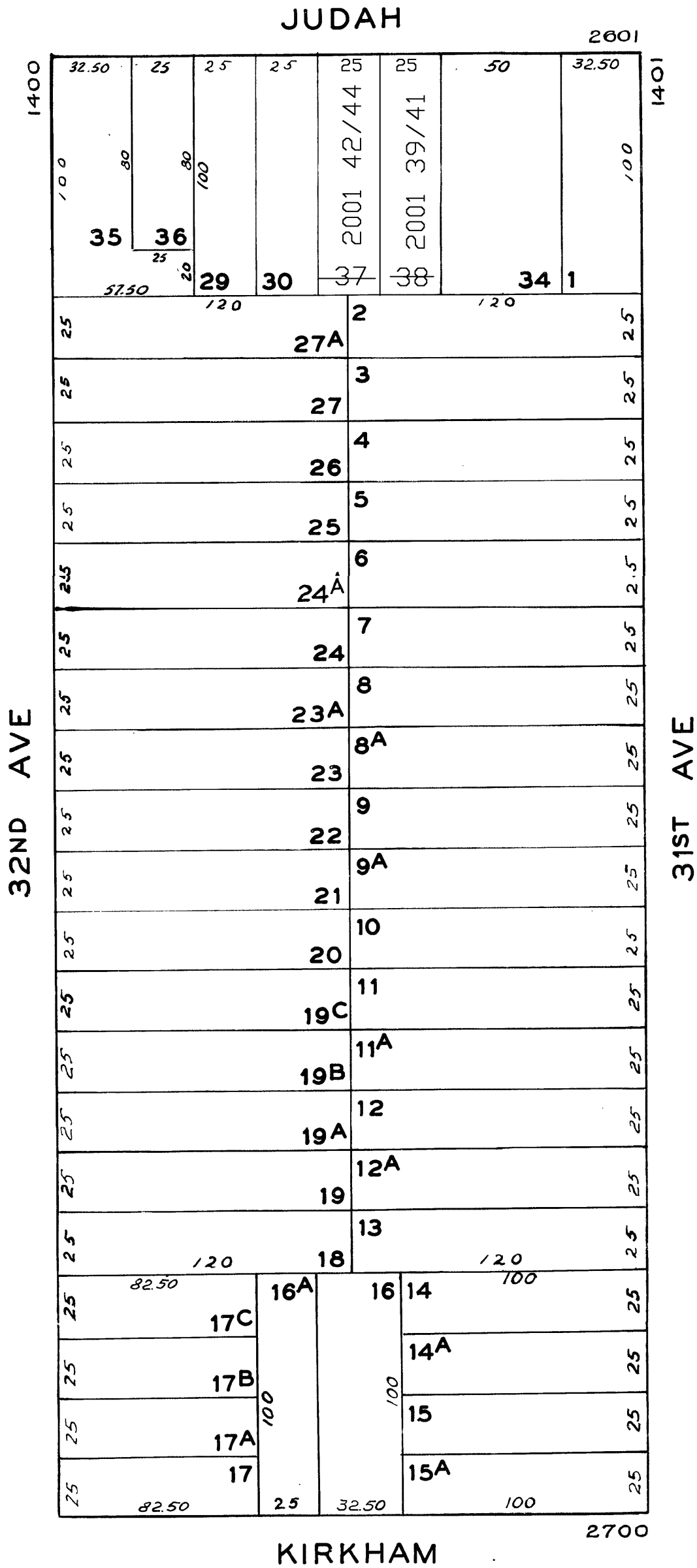
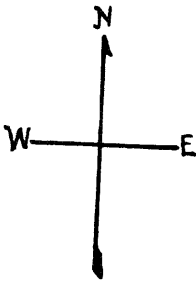

2621 JUDAH ST.  
A CONDOMINIUM  
LOT UNIT % COMM. AREA

39	1	33.36
40	2	33.91
41	3	32.73

2625 JUDAH ST.  
A CONDOMINIUM

LOT	UNIT	% COMM. AREA
42	1	33.36
43	2	33.91
44	3	32.73