

lot 26 into lots 44/46 for 1999 roll
lot16 into lots47to49 for 2000 roll
lot35 into lots50&51 for 2002 roll
lot12 into lots 56&57 for 2003 roll
lot25 into lots52/55 for 2004 roll
lot19 into lots58to61 for 2005 roll
lot6 into lots64/67 for 2010 roll
lot9 into lots70&71 for 2014 roll
Lot 5A into lots 72 to 74 for 2015 roll
Lot 3 into lots 66 to 68 for 2015 roll

19TH

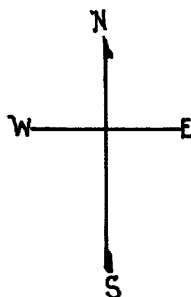

COLLINGWOOD

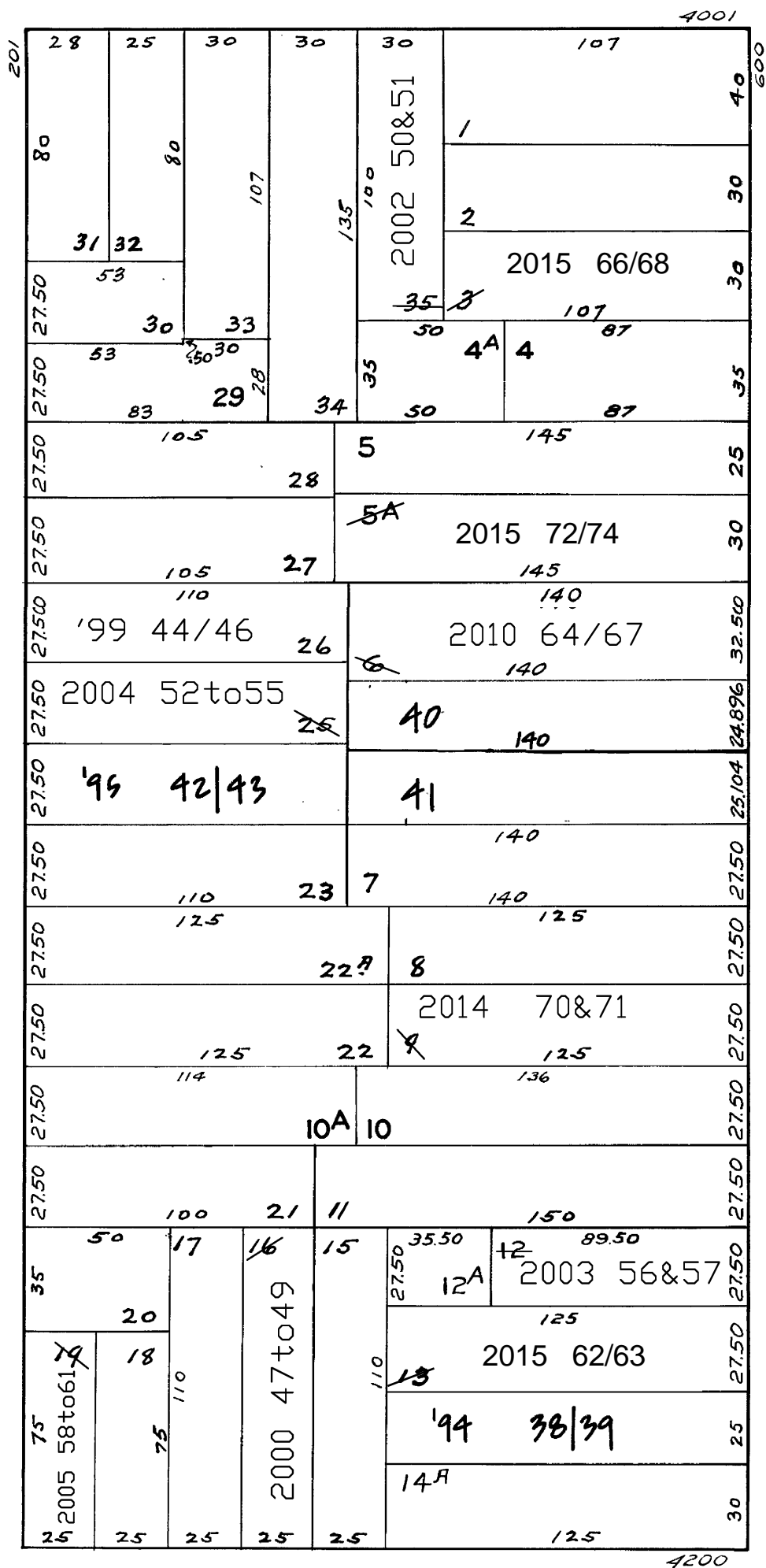

20TH

HORNERS ADDN. BLK. 193

REVISED '74
" '94
" '95

Revised '99
Revised 2000
Revised 2002
Revised 2003
Revised 2004
Revised 2005
Revised 2010
Revised 2014
REVISED 2015

4250-4252 20TH AVE. & 283 COLLINGWOOD ST.

A CONDOMINIUM

LOT	UNIT	% COMM. AREA
58	283	25
59	4250-1	17
60	4250-2	23
61	4252	35

241-243 COLLINGWOOD ST.

A CONDOMINIUM

LOT	UNIT	% COMM. AREA
52	241A	33.28
53	241B	22.24
54	241C	22.24
55	243	22.24

4230-4234-4238 TWENTIETH ST.

A CONDOMINIUM

LOT	UNIT	% COMM. AREA
47	4230	37
48	4234	33
49	4238	30

4127-4129 19TH ST.

A CONDOMINIUM

LOT	UNIT	% COMM. AREA
50	4127	51.9
51	4129	48.1

237-239 1/2 COLLINGWOOD STREET

A CONDOMINIUM

LOT	UNIT	% COMM. AREA
44	237	27.11
45	239	45.55
46	239 1/2	27.34

690-692 CASTRO ST.

A CONDOMINIUM

LOT	UNIT	% COMM. AREA
38	690	92.5
39	692	47.5

245-245A COLLINGWOOD ST.

A CONDOMINIUM

LOT	UNIT	% COMM. AREA
42	1	43.60
43	2	56.40

678-680 Castro St.

A CONDOMINIUM

LOT	UNIT	% COMM. AREA
56	678	50
57	680	50