

LOTS MERGED

LOT 12 INTO LOT 8-1923
lots15,16,36&37 into lot39 for 2001 roll
lot39 into lots40/49 for 2001 roll
lot23 into lots50&51 for 2007 roll
Lot 17 into lots 61/63 for 2015 roll

MARKET ST. HD. ASSN. BLK. 22

REVISED '57
" '58
" '61
" '62
" '64
" '73

Revised 2001
REVISED 2015

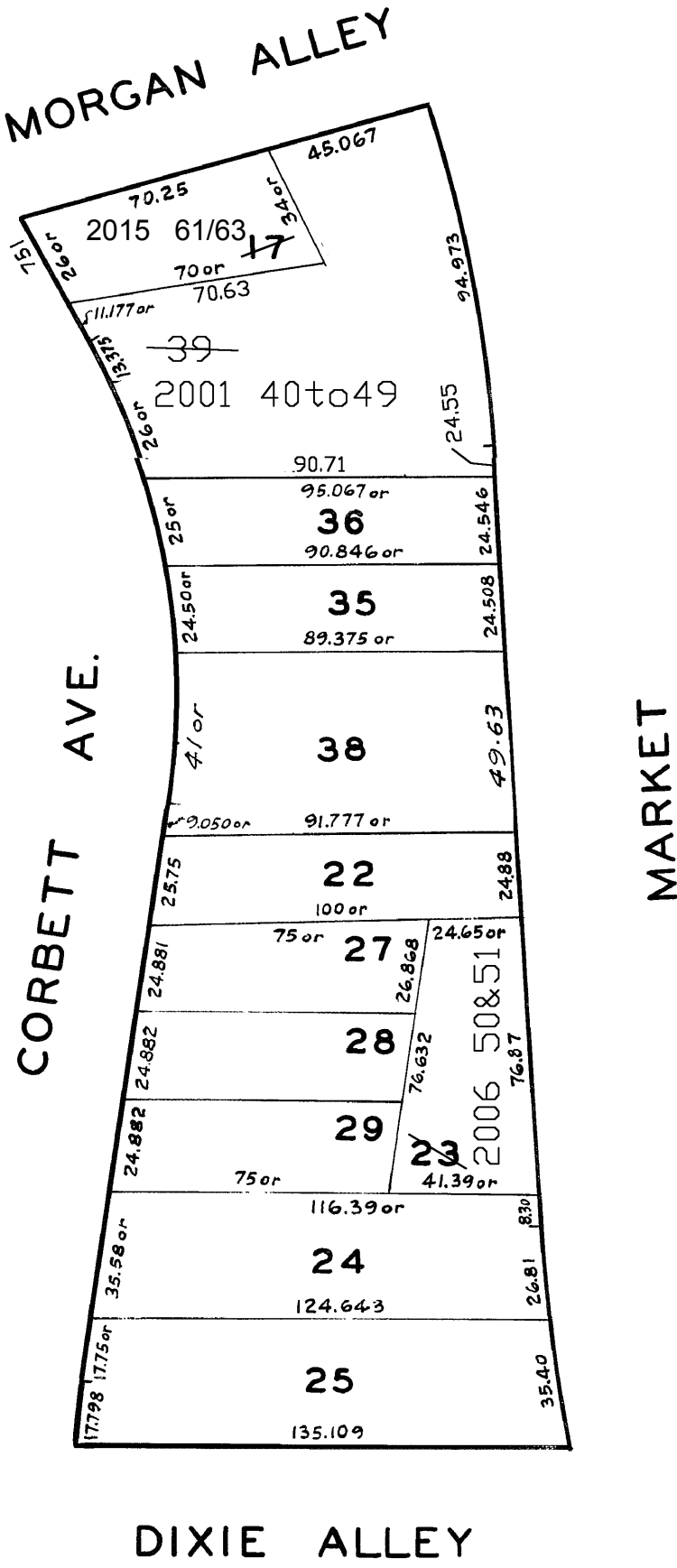
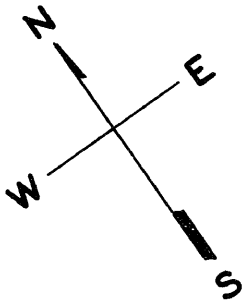

767 CORBETT AVE. A CONDOMINIUM			3750 MARKET ST. A CONDOMINIUM		
LOT	UNIT	% COMM. AREA	LOT	UNIT	% COMM. AREA
40	1	9.87	50	1	47.63
41	2	8.97	51	2	52.37
42	3	9.43			
43	4	9.04			
44	5	9.30			
45	6	10.97			
46	7	11.09			
47	8	10.63			
48	9	10.53			
49	10	10.17			