

14, 11 11 71, 72-76

6244

REIS TR BLK. 17

© COPYRIGHT SAN FRANCISCO
CITY & COUNTY ASSESSOR 1995
lots39&75 into lots78to80 for 2006 roll

LOTS MERGED

Lots	into Lot	19-
15,16	14	'45
40	39-41	"46"
2/4	1, 55/57	"51"

REVISED '58
REVISED '60
REVISED 1962
REVISED 1970
" '74
" '76
" '85
" '89
Revised 2006

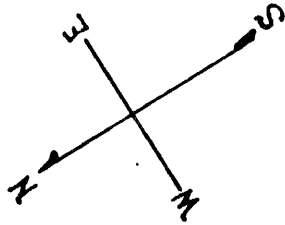

RAYMOND AVE.

LELAND AVE.

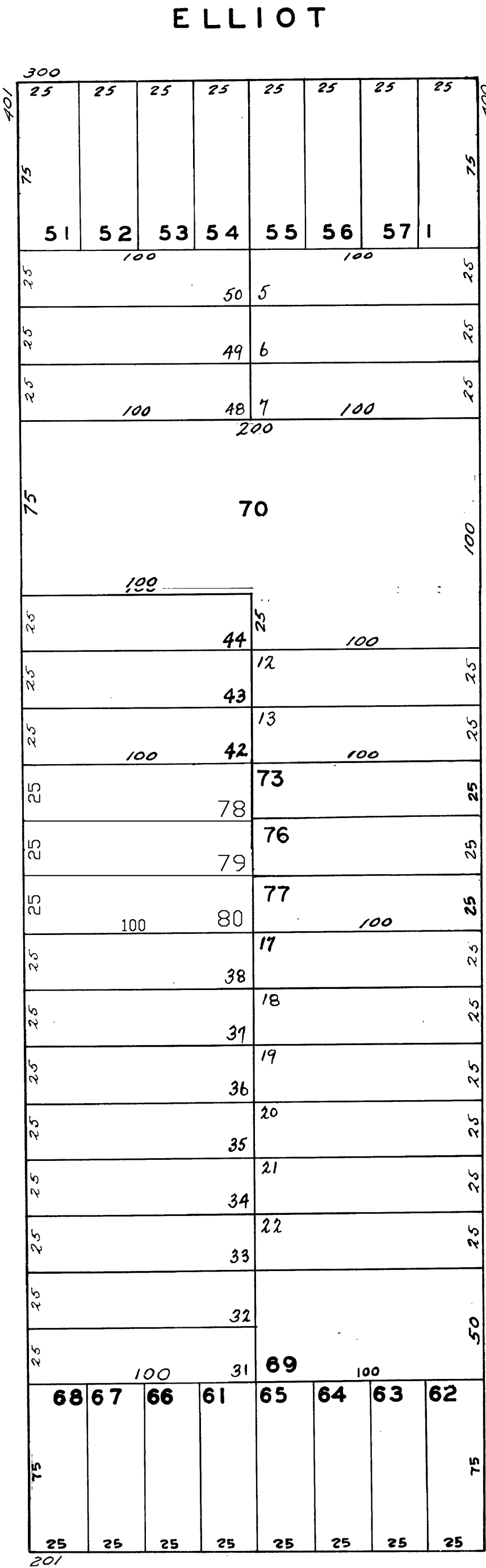

SAWYER