

lot36 into lots63&64 for 2008 roll
lot52 into lots65to70 for 2009 roll
Lots 21 & 22 into lot 80 for 2017 roll

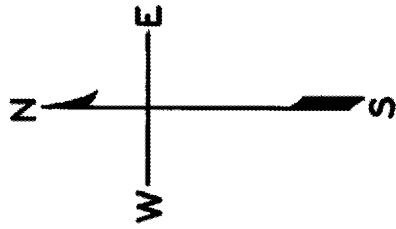

NOE

ARMY

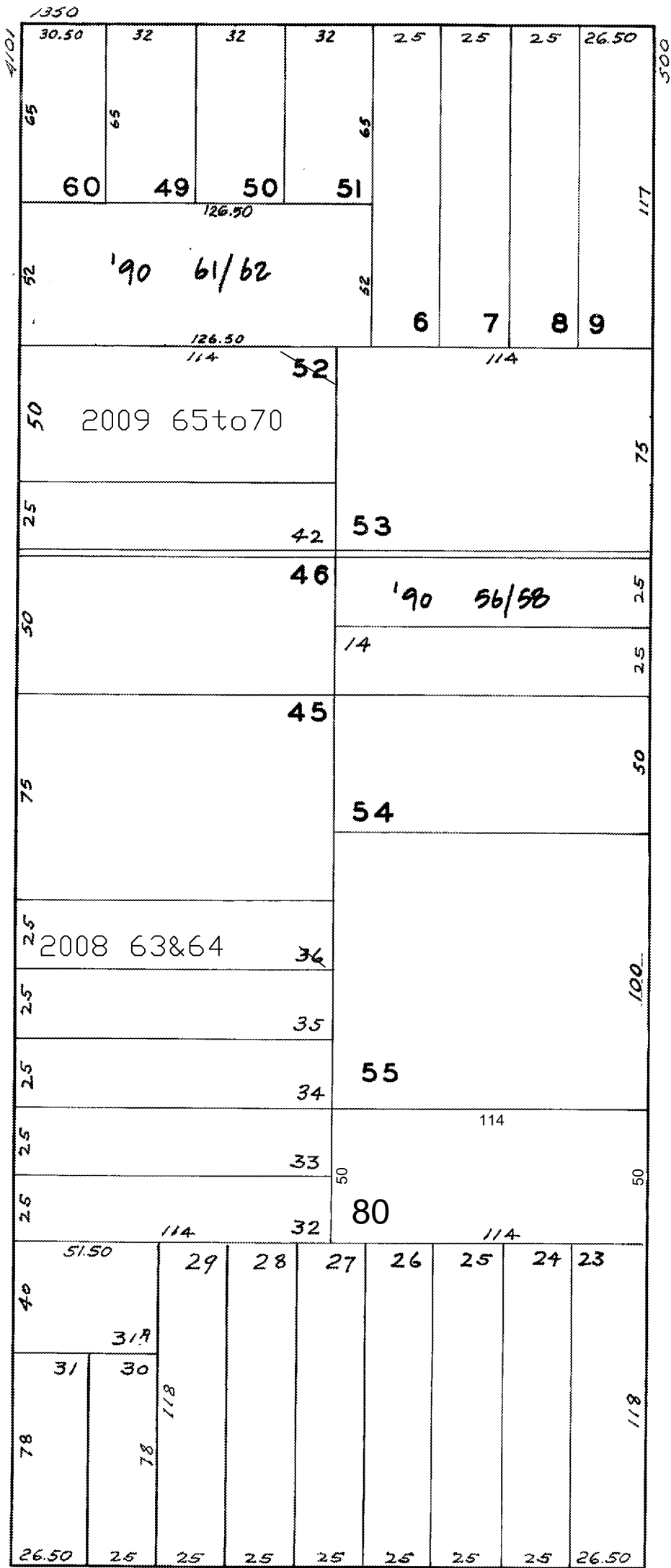

CASTRO

6581

HORNER'S ADD
BLK 166

REVISED	'63
"	'66
"	'68
"	'71
"	'75
"	'85
"	'90
Revised	2008
Revised	2009
REVISED	2017

27TH

4115 ARMY ST.

A CONDOMINIUM

LOT	UNIT	% COMM. AREA
61	1	58.38
62	2	41.62

536 - 27TH ST.

A CONDOMINIUM

LOT	UNIT	% COMM. AREA
56	1	26.1
57	2	21.4
58	3	52.5

lot36 into lots63&64 for 2008 roll